

PARTS LIST

Remote Engine Starter Unit Kit P/N 08E91-E54-100

Transmitter

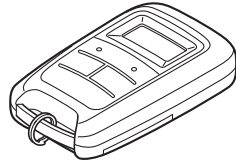

Control unit

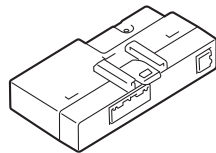

Antenna

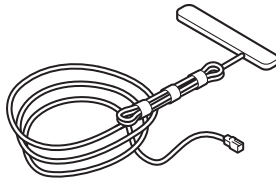

ID label

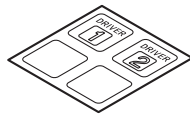

Remote Control Engine Starter Attachment Kit P/N 08E92-T5A-100

Engine starter harness

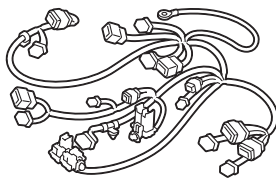

Control unit bracket



3 Relays

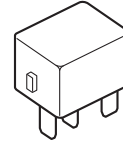

21 Wire ties

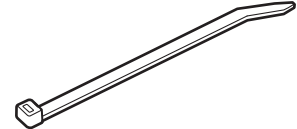

6 Long wire ties

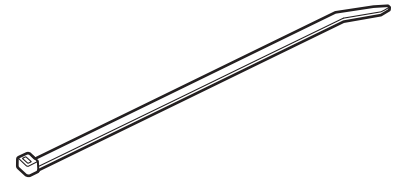

Wire tie with clip

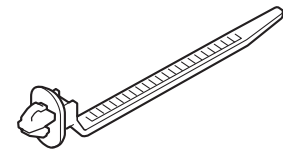

Ground bolt



2 Aluminum tapes



8 Urethane tapes

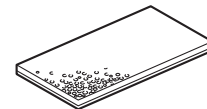

Caution label

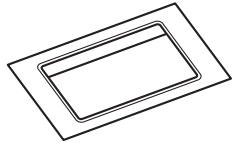

Fuse label

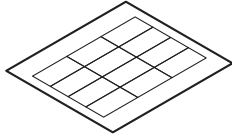

Clip

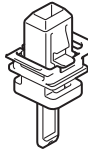

Accessory User's Information Manual

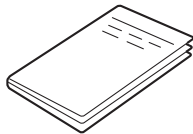

Quick Start Guide

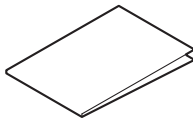

TOOLS AND SUPPLIES REQUIRED

Phillips screwdriver

Flat-tip screwdriver

Diagonal cutters

Ratchet

10 mm Socket

10 mm Open end wrench

Isopropyl alcohol

Scissors

Shop towel

Ruler

Tape measure

HDS/MVCI

Masking tape

Tape

The following tools are available through the Honda Tool and Equipment Program. On the iN, click on: Service > Service Bay > Tool and Equipment Program, then enter the number under "Search". Or, call 888-424-6857.

- Trim Tool Set (T/N SOJATP2014)
- Plastic Trim Tool (T/N SILTRIMTL10)

Illustration of the Remote Control Engine Starter Installed on the Vehicle

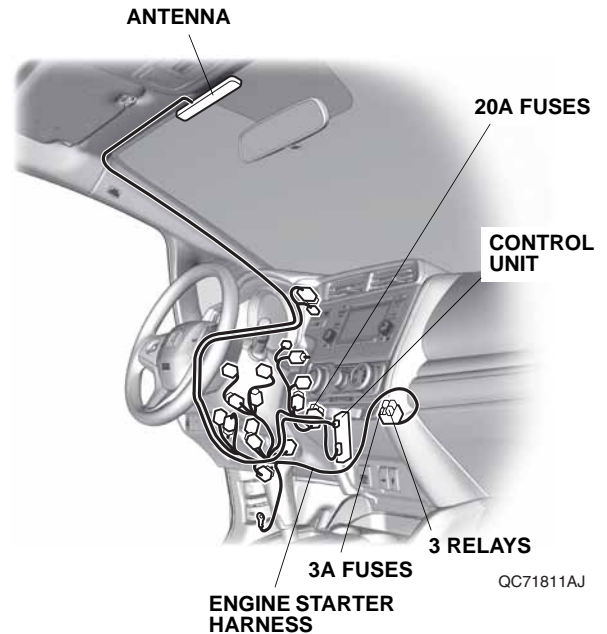

INSTALLATION

Customer Information: The information in this installation instruction is intended for use only by skilled technicians who have the proper tools, equipment, and training to correctly and safely add equipment to your vehicle. These procedures should not be attempted by “do-it-yourselfers.”

NOTE: This antenna should only be installed if the ambient air temperature 15°C (60°F) or above.

1. Disconnect the negative cable from the battery.
2. Attach the ID label.
 - Using isopropyl alcohol on a shop towel, clean the transmitter where the ID label will attach.
 - Attach the ID label to the transmitter in the area as shown.

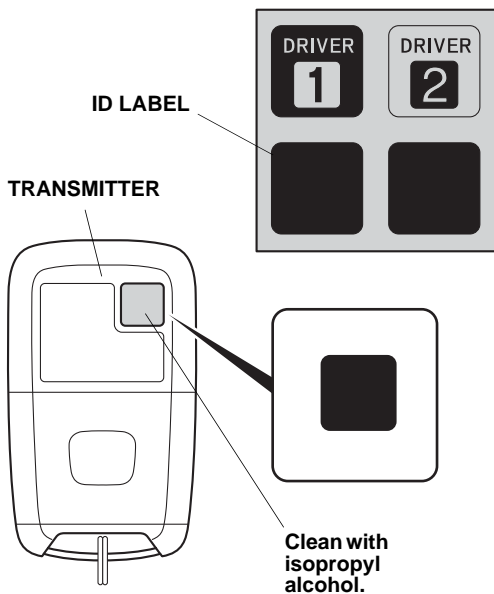

QBD0601AE

3. Remove the driver's sunvisor:
 - Pivot the driver's sunvisor downward.
 - Wrap tape around the tip of flat-tip screwdriver.
 - Locate the slot in the base cover, and insert the flat-tip screwdriver into the slot. Push in and hold the retaining tab.
 - While holding the retaining tab, push up on the sunvisor and rotate it.

NOTE: If the retaining tab did not stay pushed in, return the sunvisor to its original position and repeat this step.

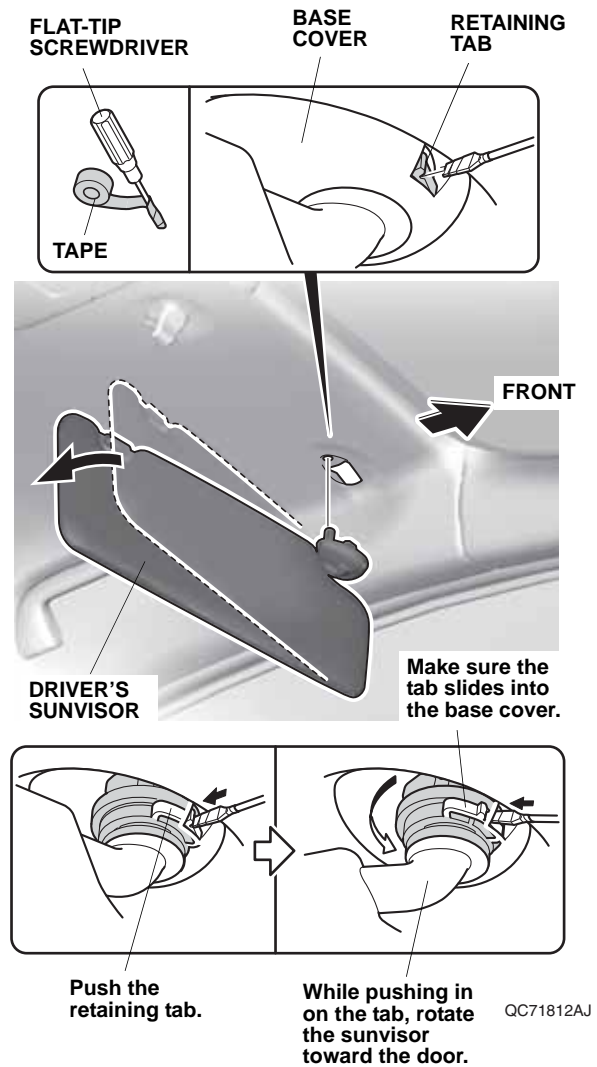

4. Remove the left sunvisor holder:
 - Wrap tape around the tip of flat-tip screwdriver.
 - Release three retaining tabs on the left sunvisor holder.

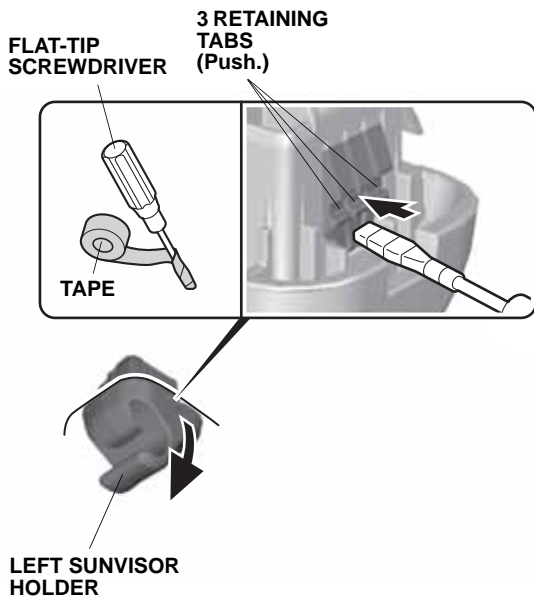

QC22003BJ

- While holding down the left sunvisor holder as shown, use a flat-tip screwdriver wrapped with a tape to remove the left sunvisor holder.

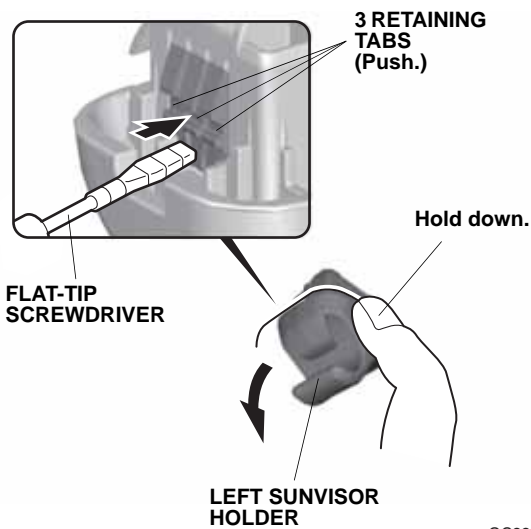

QC22004AJ

5. Remove the driver's A-pillar trim.
 - Pull back the door opening seal from the driver's A-pillar trim.
 - Pull out on the driver's A-pillar trim to release three clips.

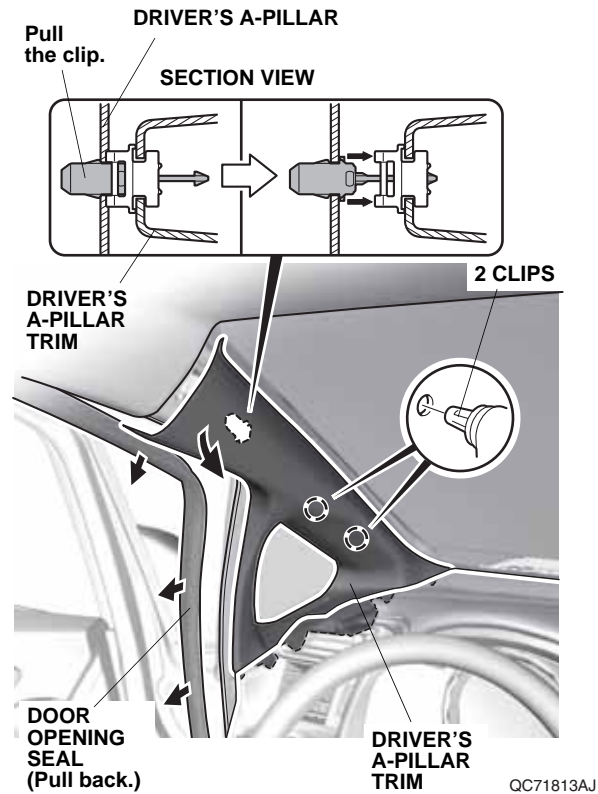

QC71813AJ

- To prevent clips from falling into the body panel area, carefully insert a shop towel between the driver's A-pillar and the driver's A-pillar trim.

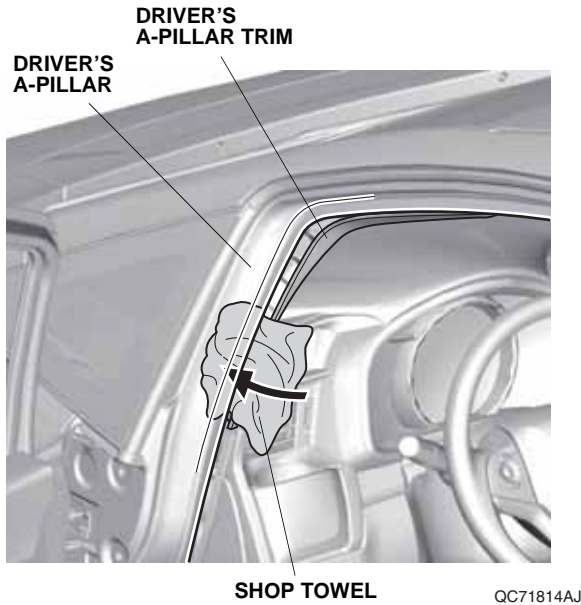

- Slide the driver's A-pillar trim upward, and remove the driver's A-pillar trim.
- Remove the shop towel and any clips.

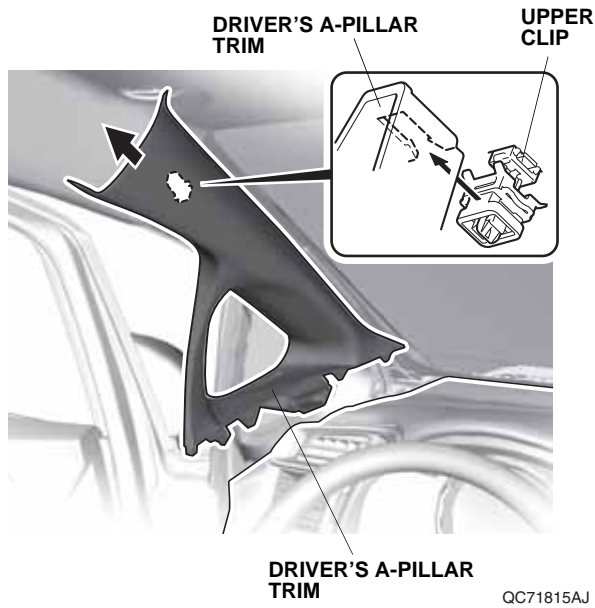

- Remove the remaining upper clip from the driver's A-pillar.

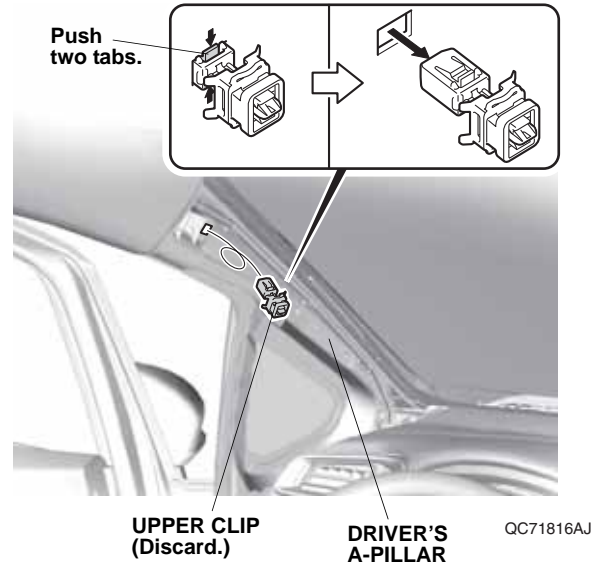

- Install the new clip (supplied) to the driver's A-pillar trim.

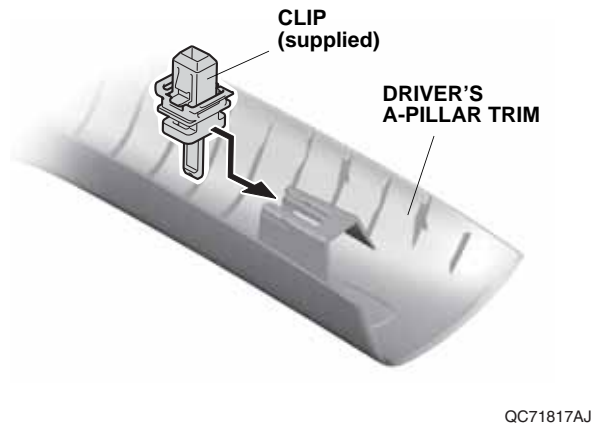

8. Pull back the door opening seal, and remove the driver's dashboard side lid.

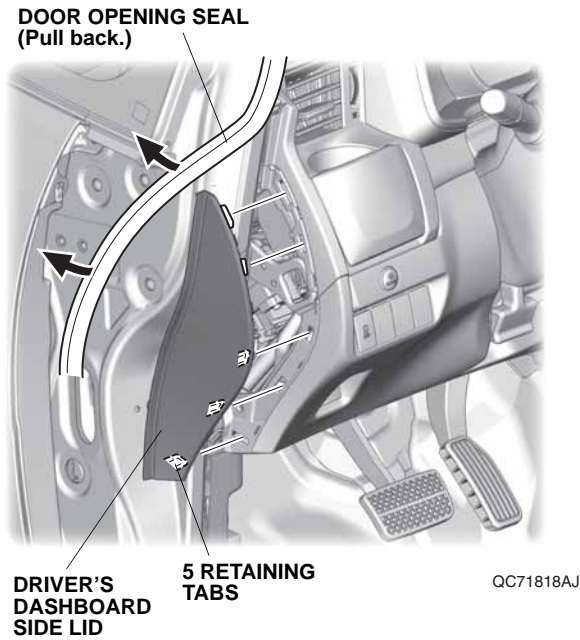

9. Remove the driver's dashboard lower cover, and unplug the vehicle connectors.

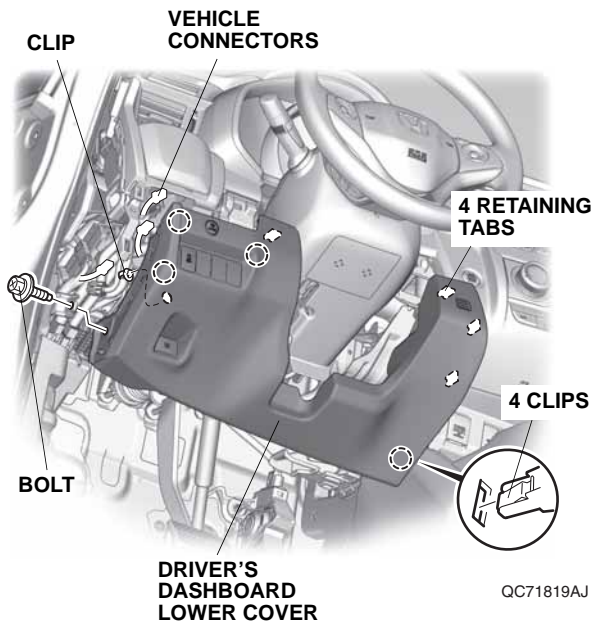

10. Pull back the door opening seal, and remove the driver's front door sill trim.

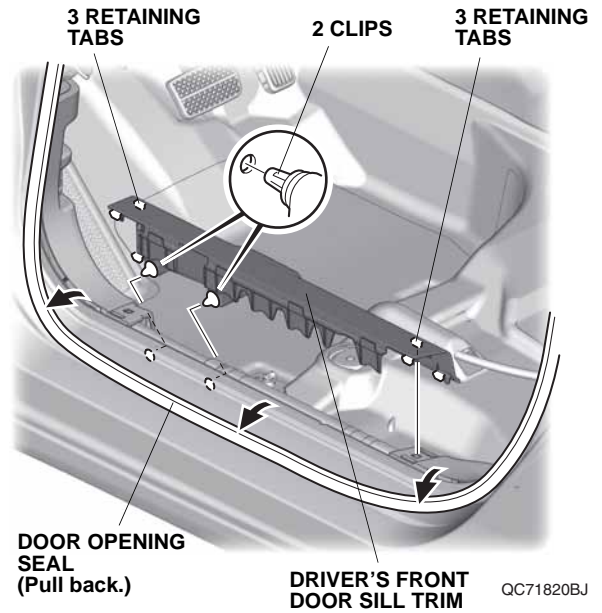

11. Pull back the door opening seal, and remove the driver's kick panel.

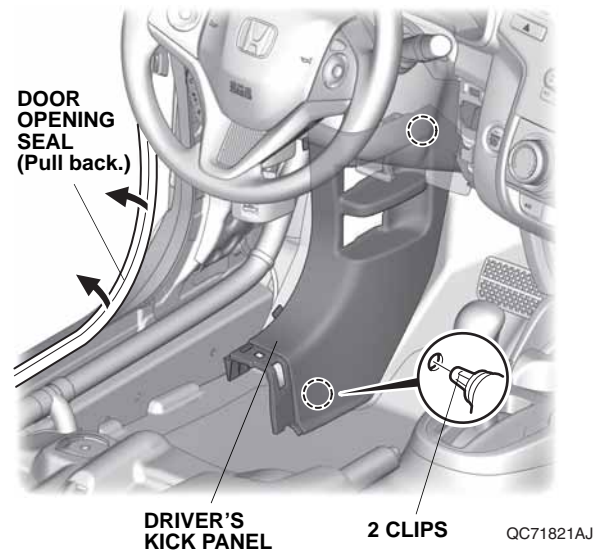

12. Lower the steering wheel. Attach the tape to the upper column cover as shown.

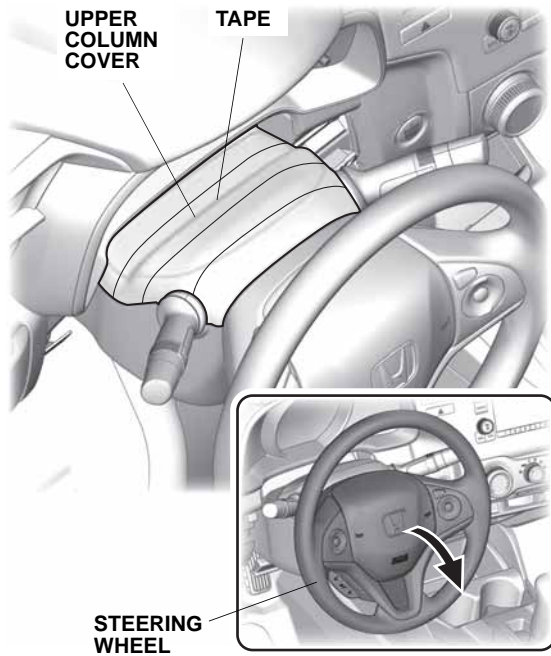

QC71822AJ

13. Turn the steering wheel 90° clockwise. Using a plastic trim tool, release the retaining tab.

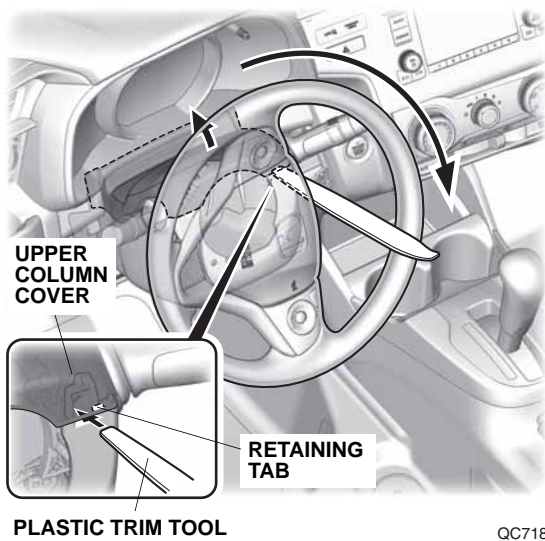

QC71823AJ

14. Turn the steering wheel 180° counterclockwise. Using a plastic trim tool, release the retaining tab.

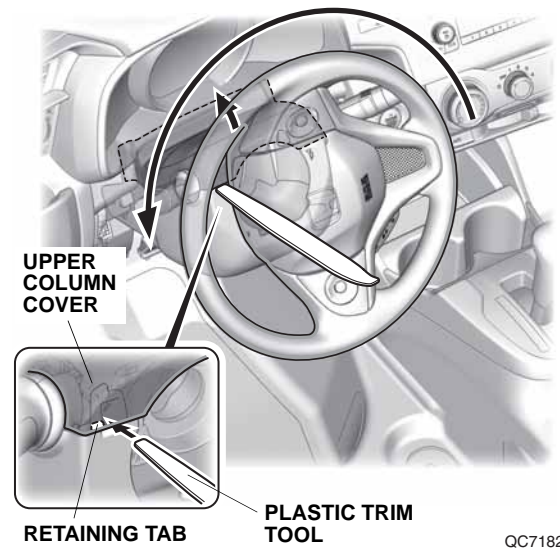

QC71824AJ

15. Remove the upper column cover.

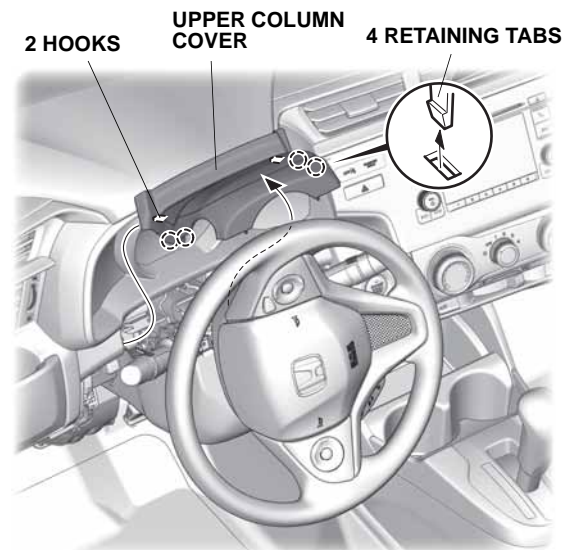

QC71825AJ

16. Remove the self-tapping screw from the lower column cover.

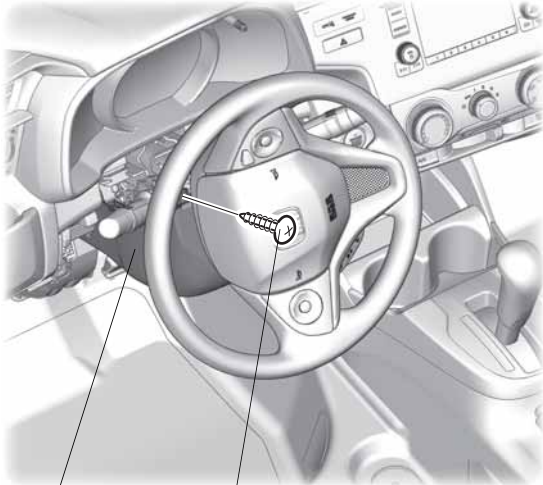

**LOWER
COLUMN
COVER**

**SELF-TAPPING
SCREW**

QC71901AJ

17. Turn the steering wheel 180° clockwise, and remove the self-tapping screw from the lower column cover.

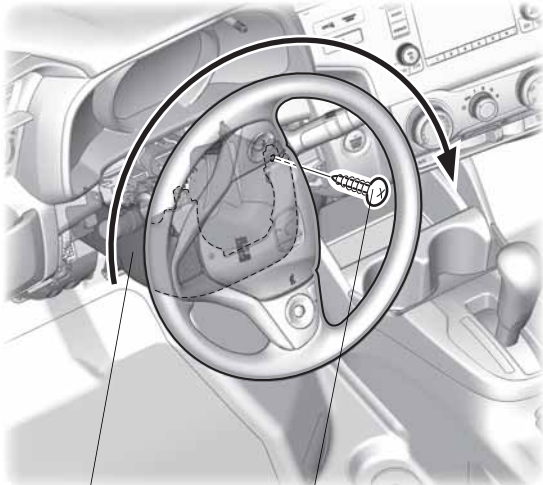

**LOWER
COLUMN
COVER**

**SELF-TAPPING
SCREW**

QC71902AJ

18. Remove the lower column cover.

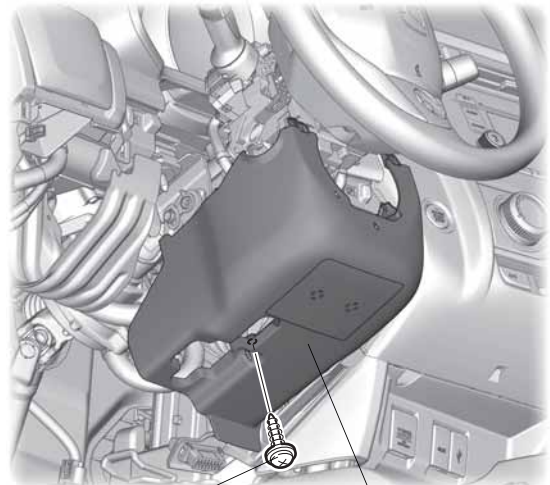

**SELF-TAPPING
SCREW**

**LOWER COLUMN
COVER**

QC71903AJ

19. Attach the tape to the instrument panel, combination light switch, and wiper switch as shown.

**INSTRUMENT
PANEL**

TAPE

**WIPER
SWITCH**

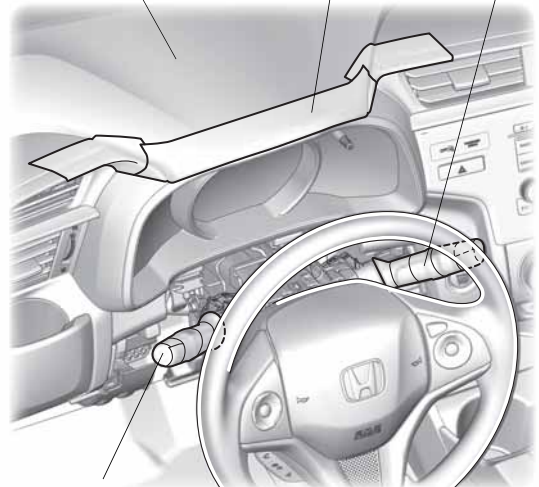

**COMBINATION
LIGHT SWITCH**

QC71904AJ

20. Remove the meter panel.

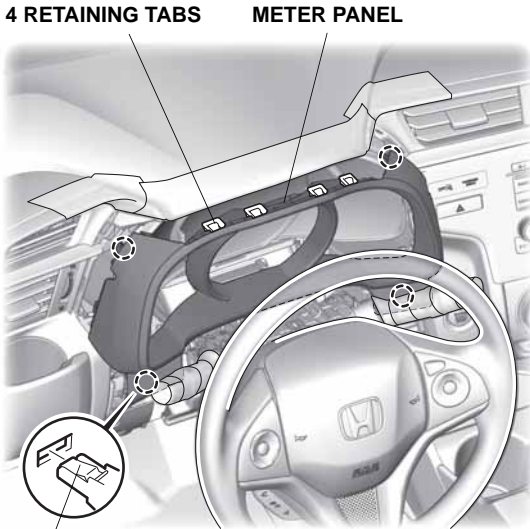

QC71905AJ

21. Pull back the door opening seal, and remove the driver's side outlet.

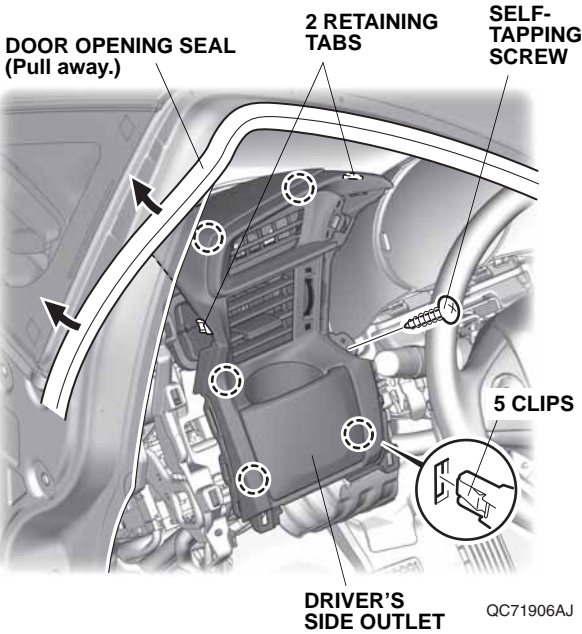

QC71906AJ

22. Attach the tape to the instrument panel, passenger's panel, and audio panel as shown.

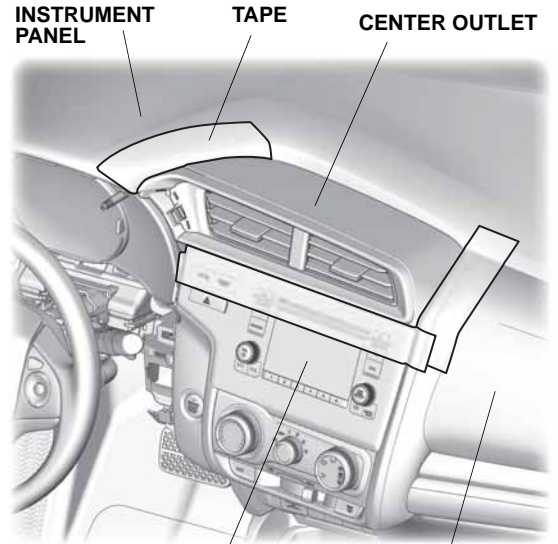

QC71907AJ

23. Remove the center outlet.

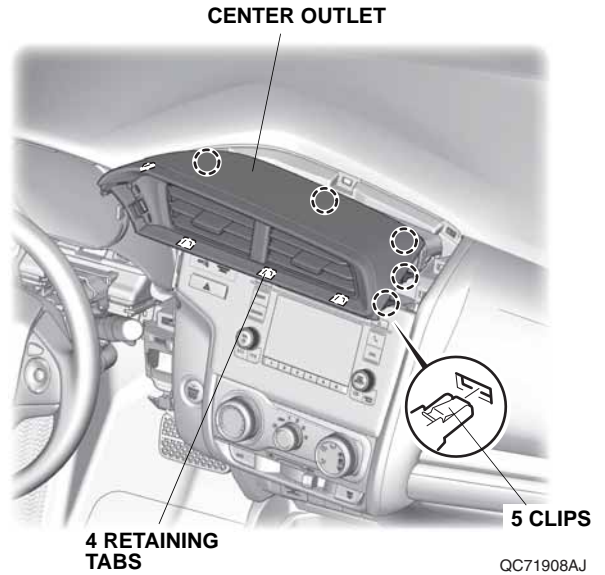

QC71908AJ

24. Remove the meter, and unplug the vehicle connector.
NOTE: Always keep the meter face up.

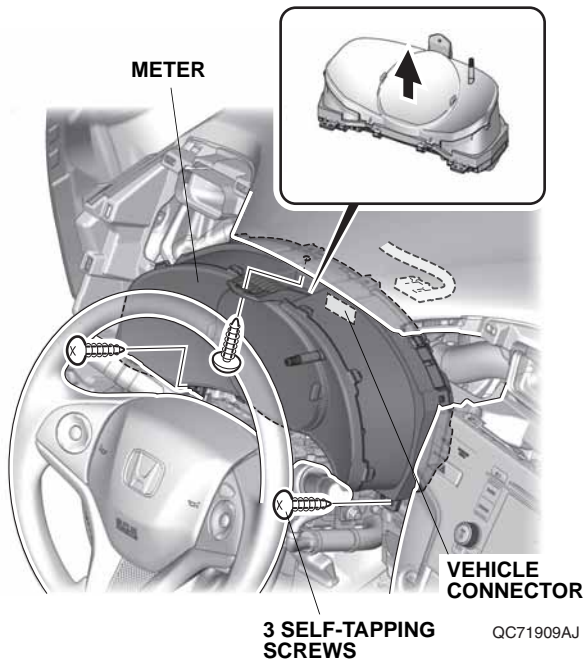

Installing the Antenna

25. Using scissors, cut one urethane tape in half. Wrap the halves of urethane tape around the antenna cable as shown.
NOTE: Do not fold the antenna cable.

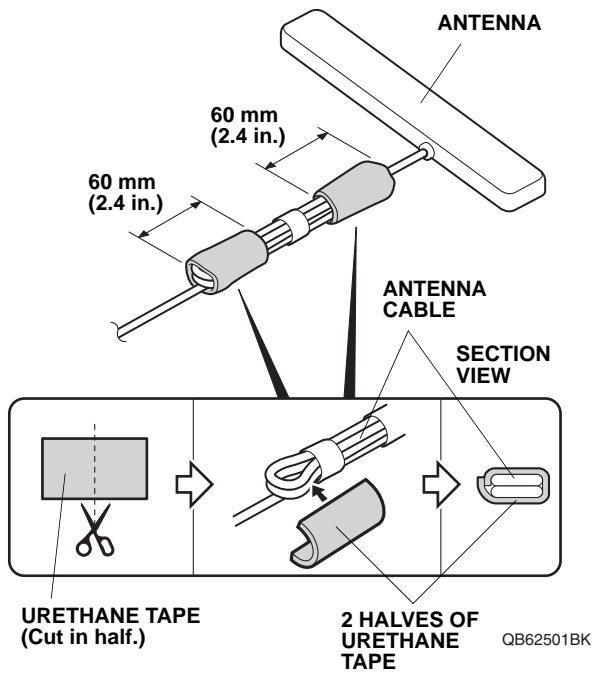

26. Using scissors, cut three urethane tapes in half. Starting near the antenna end of the cable, wrap five halves of urethane tape around the antenna cable as shown.

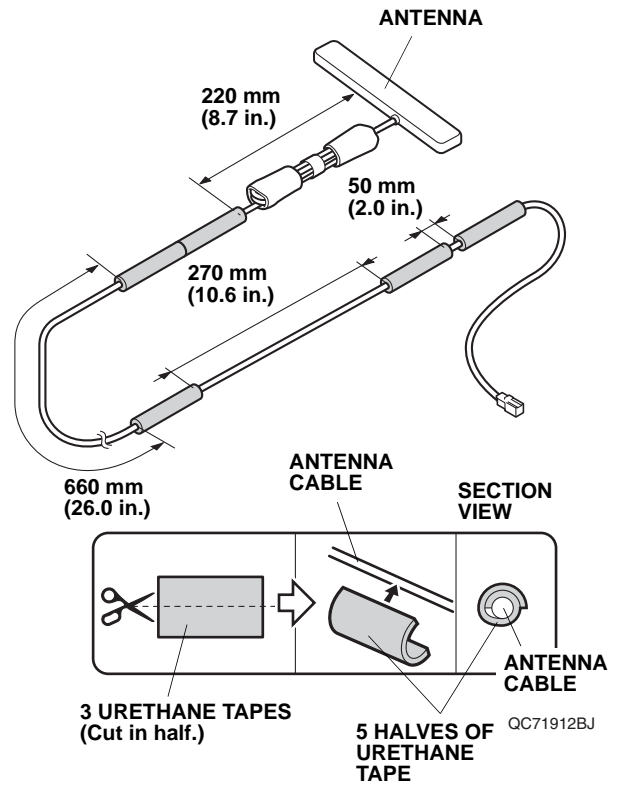

27. Attach the antenna.

- Attach masking tape to the windshield at the measurement shown.

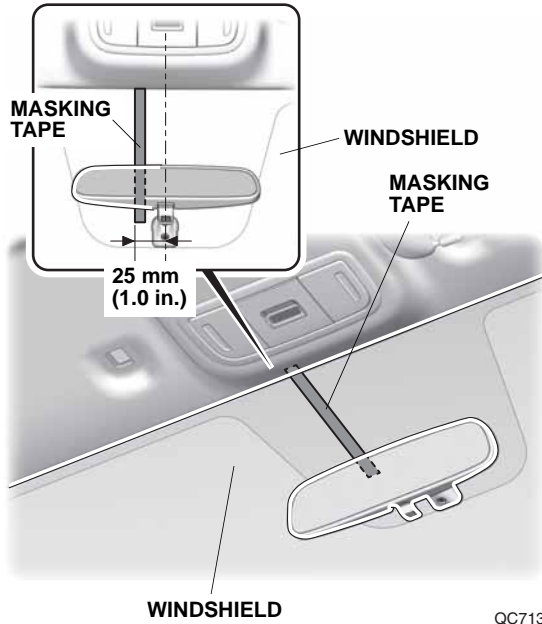

- Fold the adhesive backing of the antenna as shown.

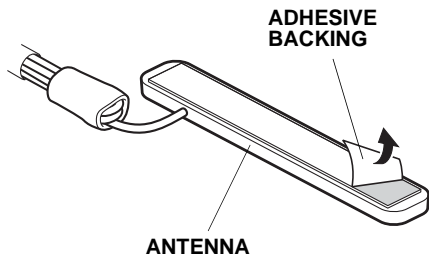

- Using isopropyl alcohol on a shop towel, clean the windshield where the antenna will attach.
- Attach the antenna with masking tape. Adjust the position of the antenna so there is equal spacing on both sides.

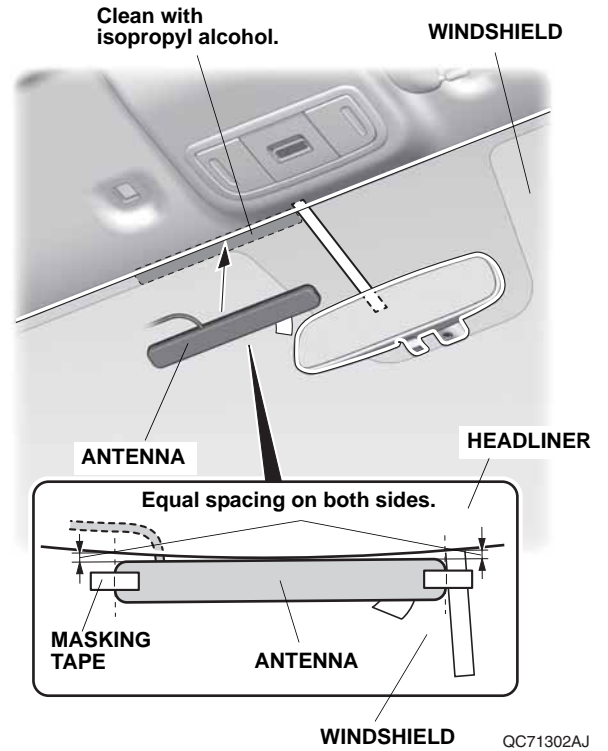

- Carefully remove the adhesive backing from the antenna, and attach the antenna to the windshield. Press and hold the antenna firmly in place for 30 seconds.
- Remove the masking tape.

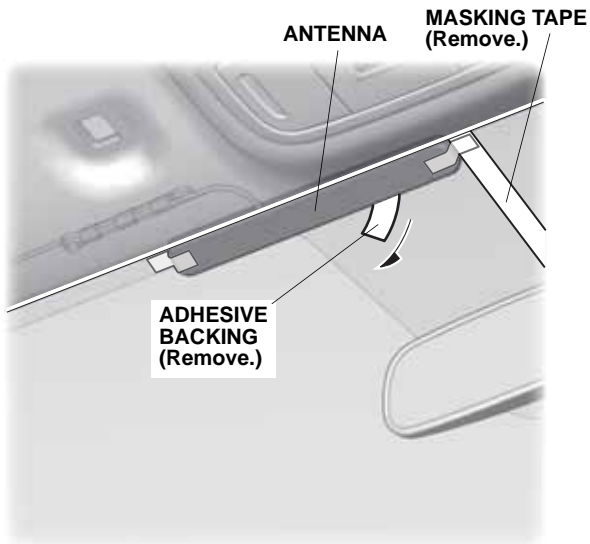

QC71303AJ

28. Gently pull down the headliner, and tuck the antenna cable under the headliner. Be careful not to crease the headliner.

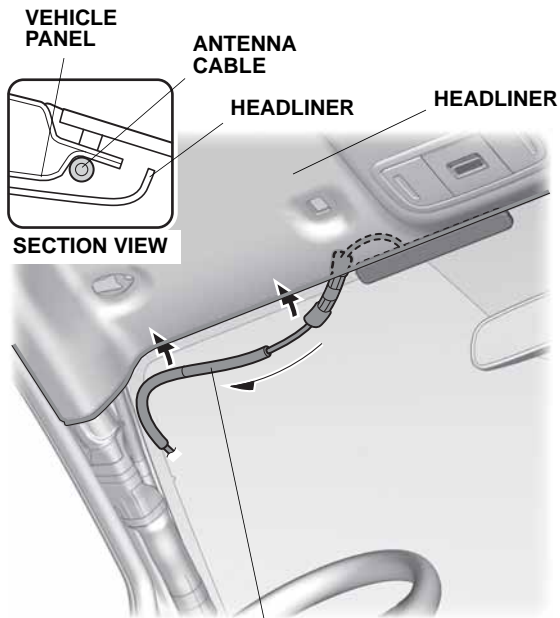

ANTENNA CABLE

QC71304BJ

29. Route the antenna cable along the A-pillar as shown. Secure the antenna cable to the vehicle harness with four wire ties.

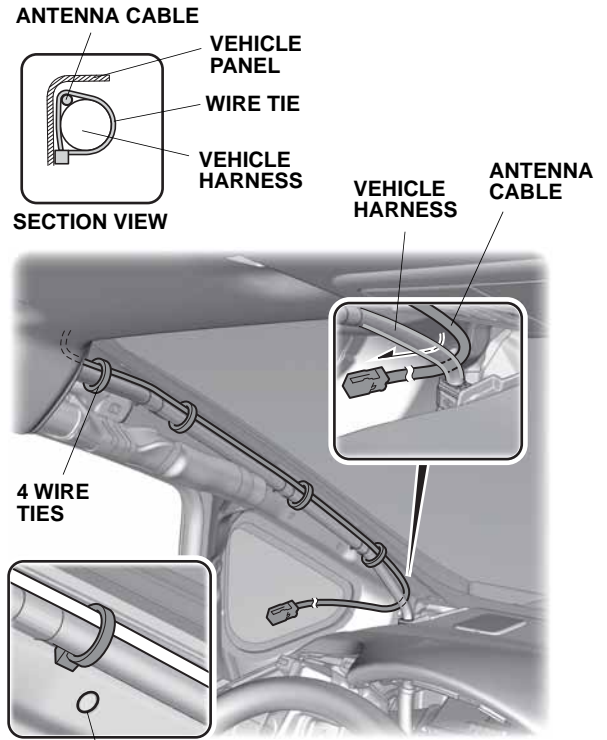

Do not cover the installation holes.

QD22201AJ

Routing the Engine Starter Harness

- Using isopropyl alcohol on a shop towel, clean the engine starter harness fuse block where the fuse labels will attach.

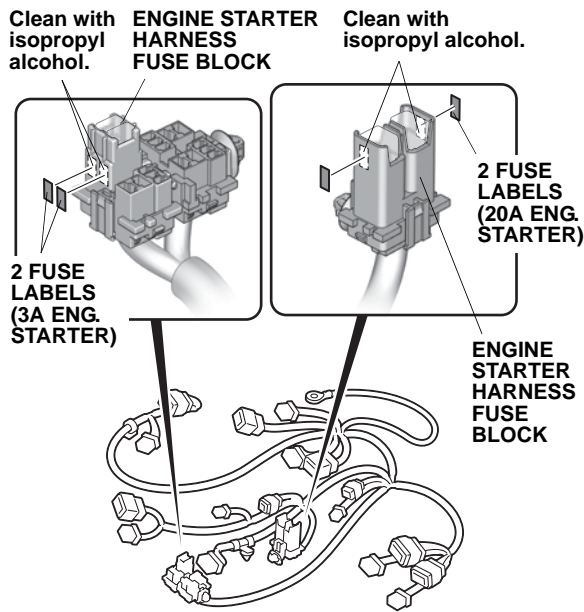

QC71306AJ

- Attach four fuse labels to the engine starter harness fuse block.
- Install three relays to the engine starter harness relay block.

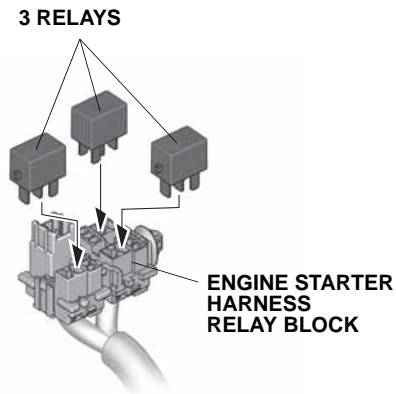

QC71307AJ

- If the vehicle is equipped with a moonroof, continue with step 33; otherwise, go to step 34.

With Moonroof

- Unplug the vehicle 18-pin connector, and plug it into the engine starter harness 18-pin connector. Plug the remaining engine starter harness 18-pin connector into the vehicle 18-pin connector. Go to step 35.

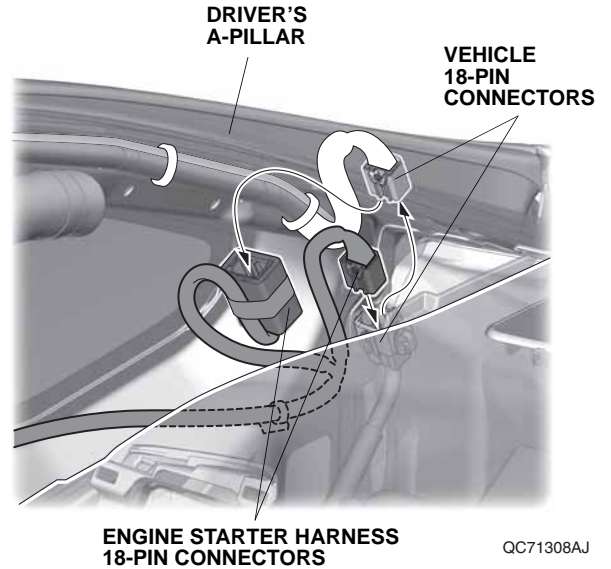

QC71308AJ

Without Moonroof

- Plug the engine starter harness 18-pin connector into the engine starter harness 18-pin connector.

ENGINE STARTER HARNESS 18-PIN CONNECTORS

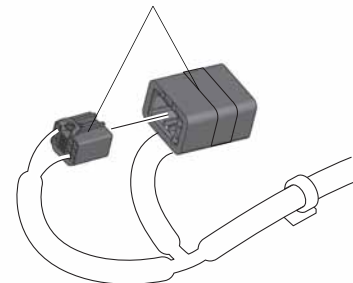

QC71309AJ

35. Attach the engine starter harness clip onto the vehicle 18-pin connector.

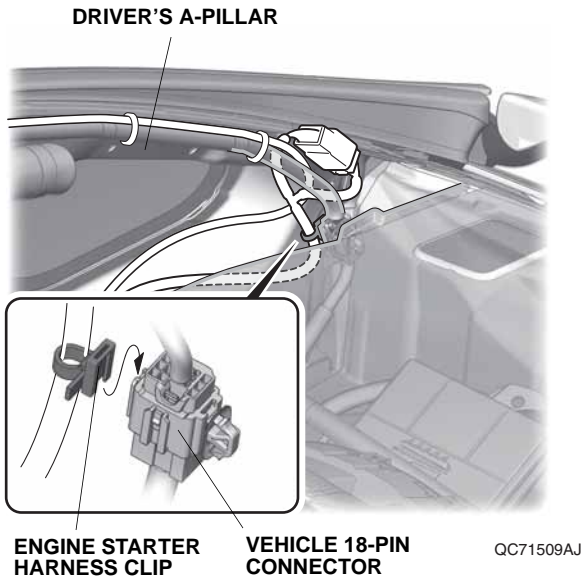

36. Secure the antenna cable, engine starter harness, and engine starter harness 18-pin connector to the vehicle harness with one wire tie.

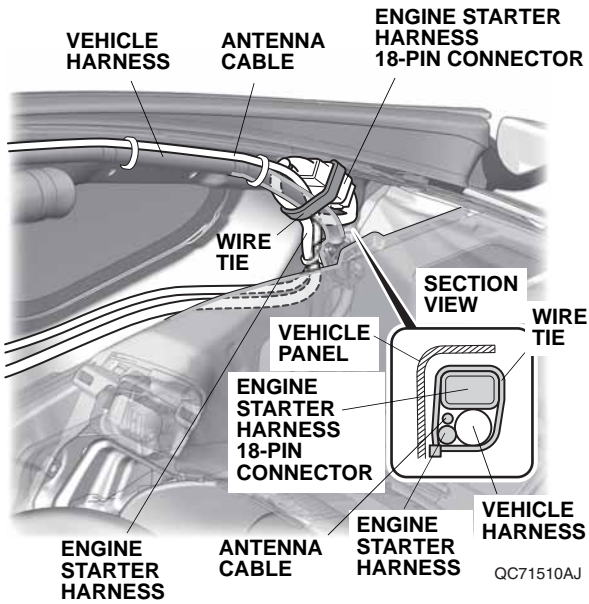

37. Pull back the door opening seal. Route the antenna cable and engine starter harness along the instrument panel, and tuck the antenna cable and engine starter harness between the driver's A-pillar and the instrument panel.

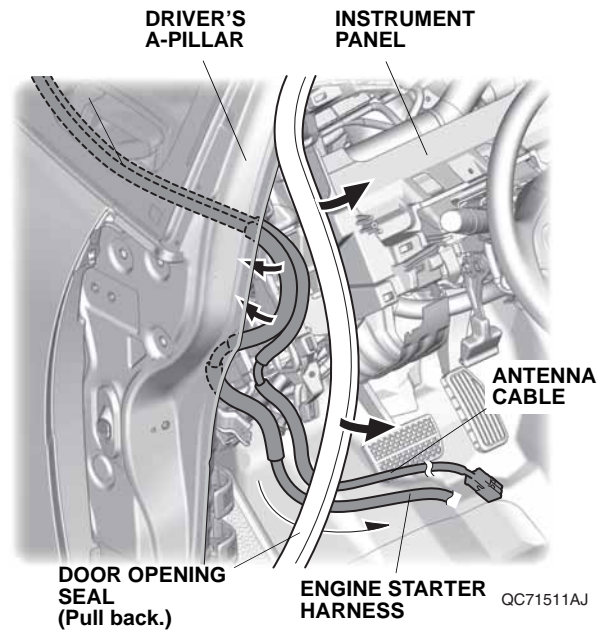

38. Using isopropyl alcohol on a shop towel, clean the driver's A-pillar where the aluminum tape will attach.

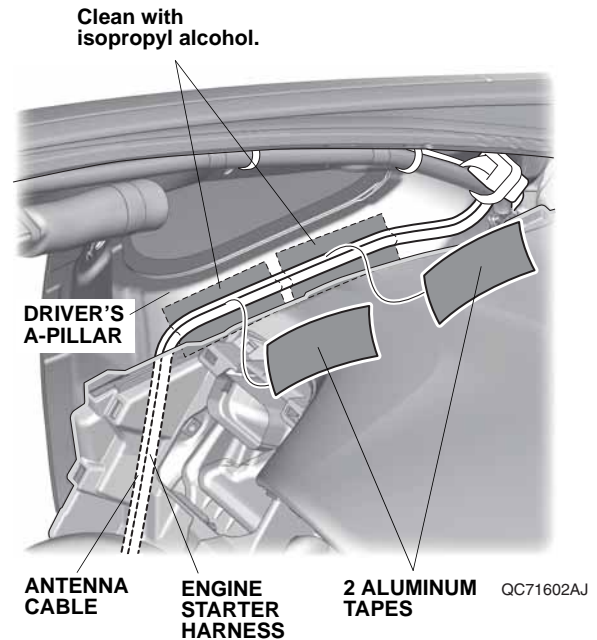

39. Attach the antenna cable and engine starter harness to the driver's A-pillar.

40. Secure the antenna cable and engine starter harness to the steering hanger beam with one wire tie.

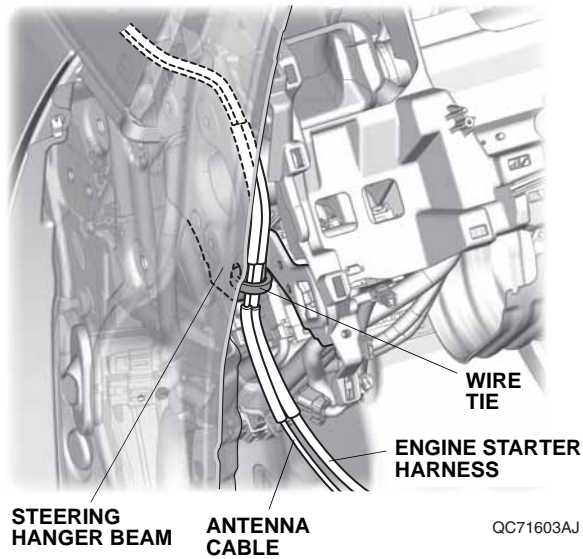

41. Using scissors, cut one urethane tape to the measurements shown. Wrap the cut urethane tape around the engine starter harness 5-pin connector.

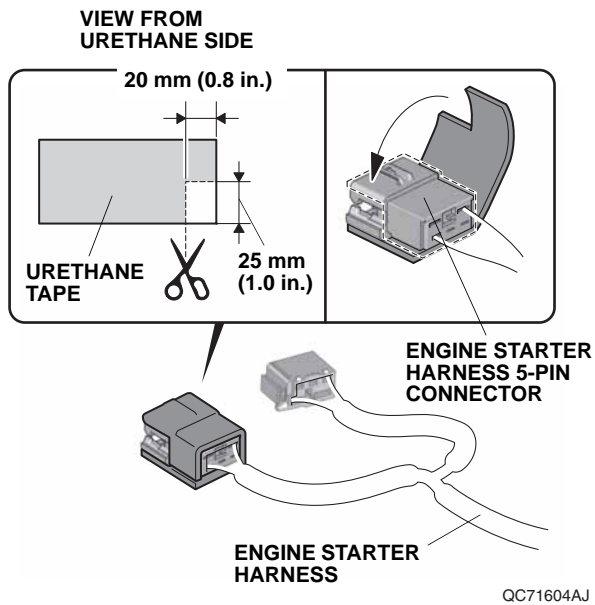

42. Release the SRS connector from the fuse box.

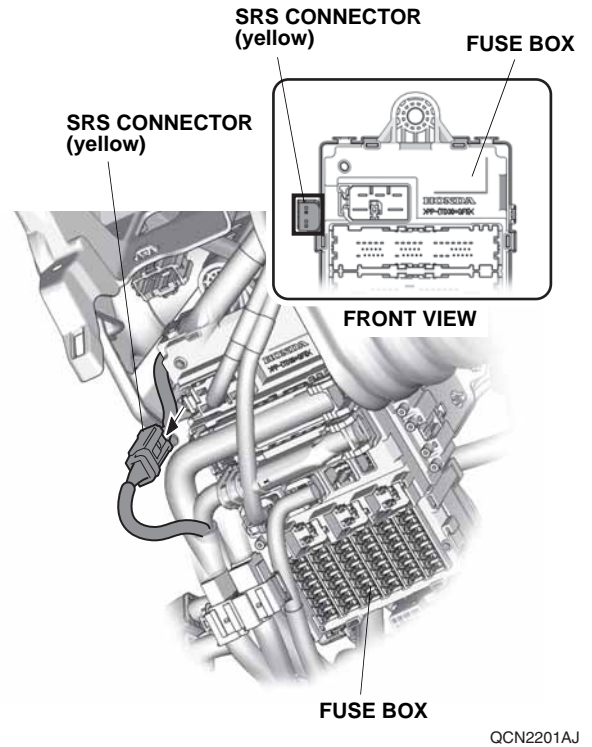

43. Unplug the vehicle 5-pin connector from the fuse box, and plug it into the engine starter harness 5-pin connector. Plug the remaining engine starter harness 5-pin connector into the fuse box.

NOTICE: Make sure the engine starter harness 5-pin connector is securely connected to the fuse box 5-pin connector. A loose connection can cause the engine to stall during driving.

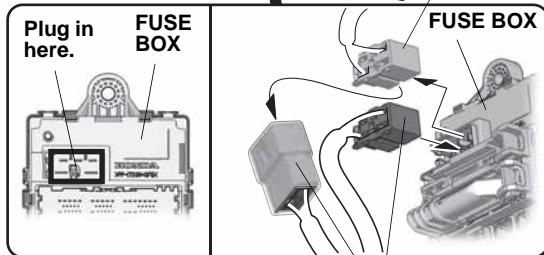
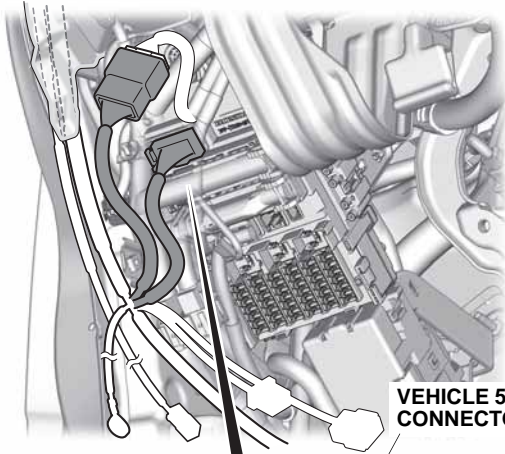
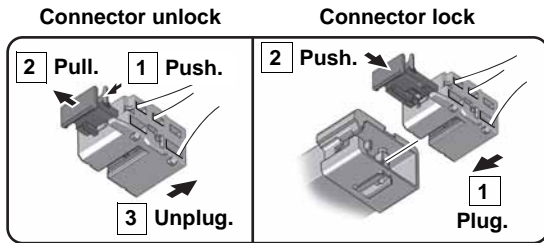

QC71605BJ

44. Reinstall the SRS connector (yellow) released in step 42.

45. Secure the engine starter harness 5-pin connector, antenna cable, and engine starter harness to the vehicle harness with two long wire ties.

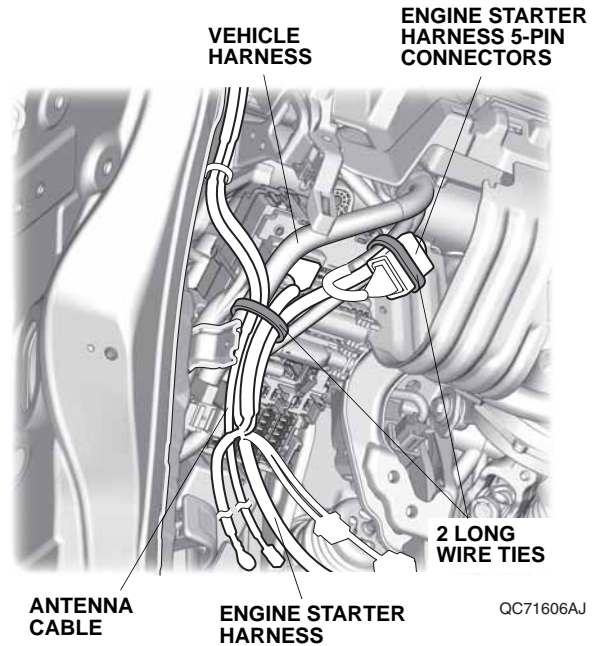

46. Route the engine starter harness along the vehicle harness. Remove the bolt, and install the engine starter harness ground terminal with one ground bolt.

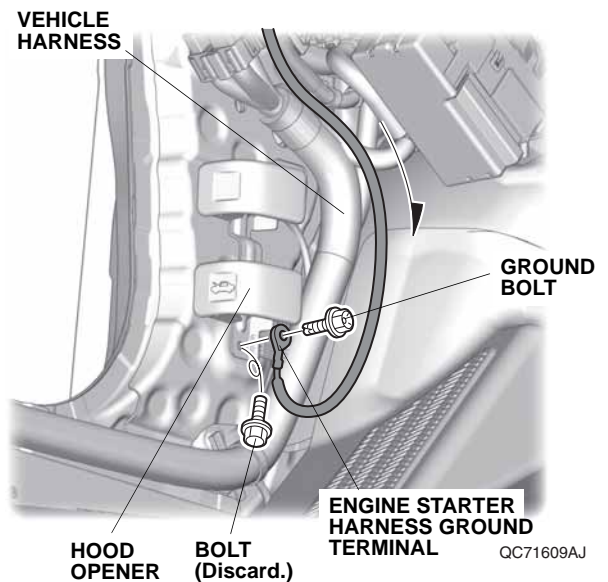

47. Secure the engine starter harness to the vehicle harness with two wire ties.

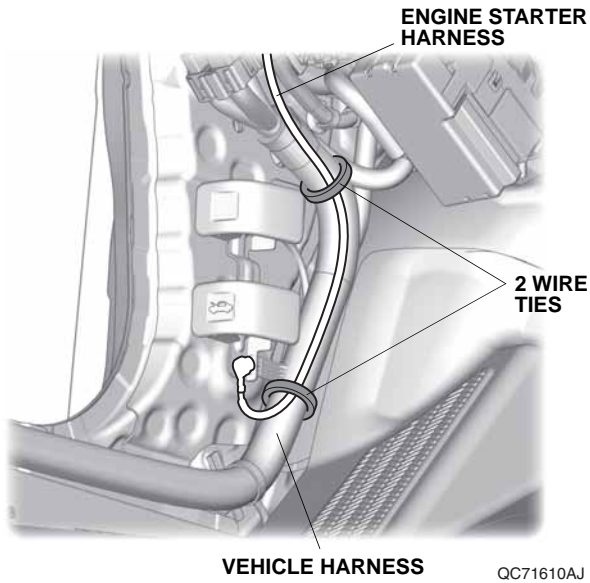

48. Release the subfuse box from the subfuse box bracket.

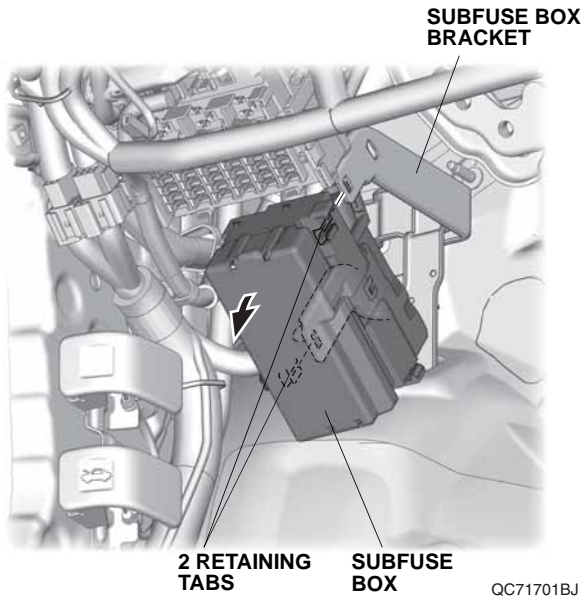

49. Remove the subfuse box bracket.

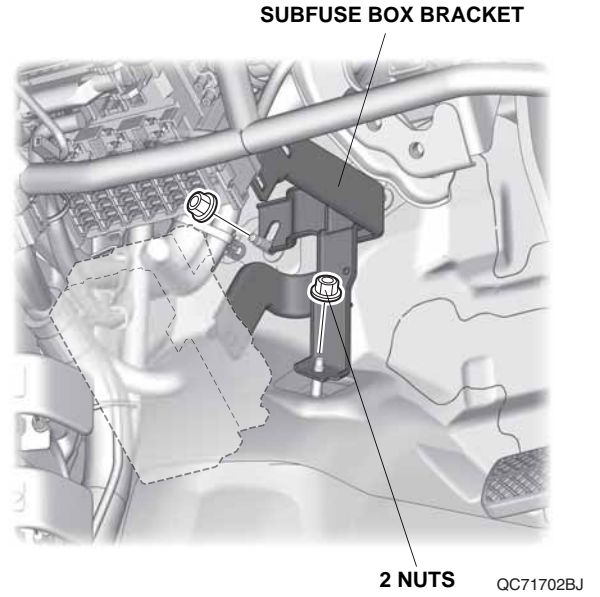

50. To gain access to the engine starter harness 20-pin connector, release the subrelay box from the steering hanger beam.

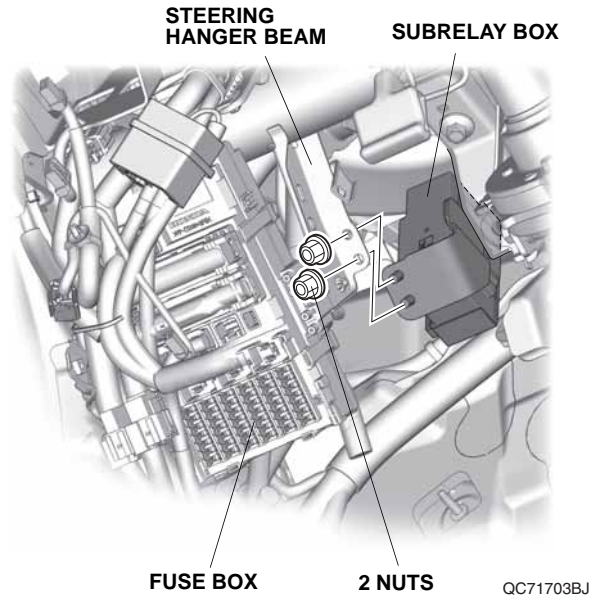

51. To gain access to the engine starter harness 20-pin connector, release the power control unit from the steering hanger beam.

POWER CONTROL UNIT **2 NUTS**

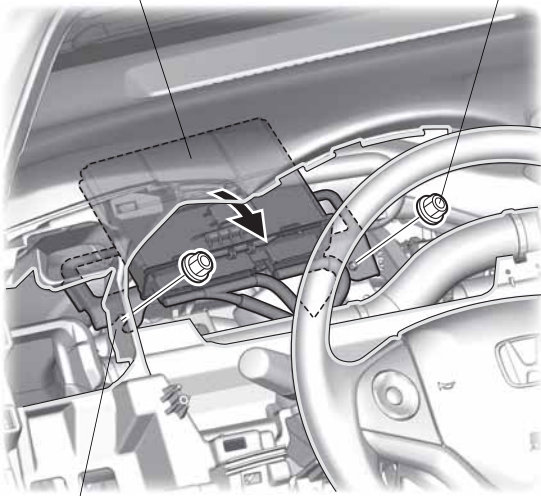

STEERING HANGER BEAM

QC71704AJ

52. Route the engine starter harness as shown.

ENGINE STARTER HARNESS 20-PIN CONNECTORS **METER OPENING**

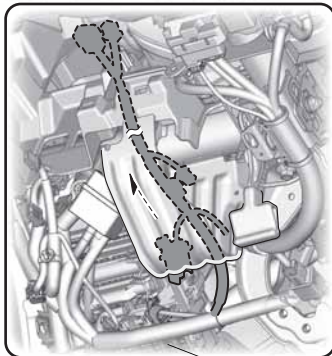
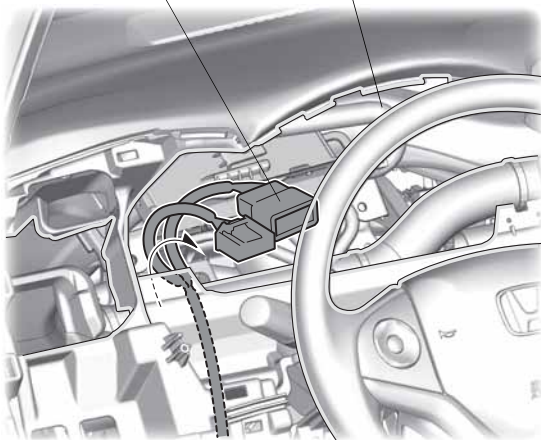

FUSE BOX

QC71705AJ

53. Unplug the vehicle 20-pin connector from the power control unit, and plug it into the engine starter harness 20-pin connector. Plug the remaining engine starter harness 20-pin connector into the power control unit.

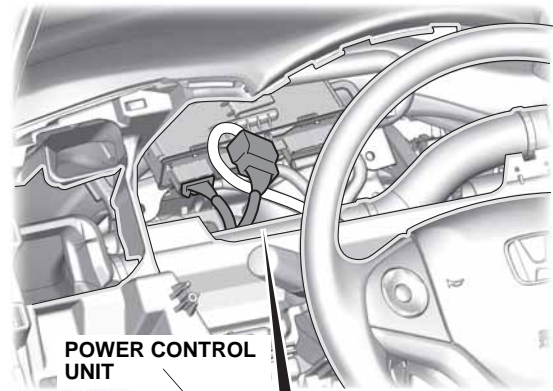

POWER CONTROL UNIT

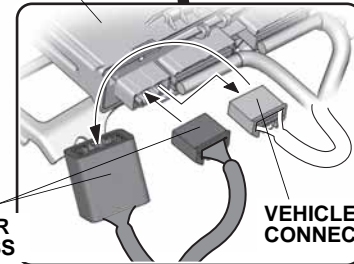

ENGINE STARTER HARNESS 20-PIN CONNECTORS

VEHICLE 20-PIN CONNECTOR

QC71706AJ

54. Reinstall the power control unit released in step 51.
55. Secure the engine starter harness 20-pin connector and engine starter harness to the vehicle harness with two long wire ties.

ENGINE STARTER HARNESS **ENGINE STARTER HARNESS 20-PIN CONNECTORS**

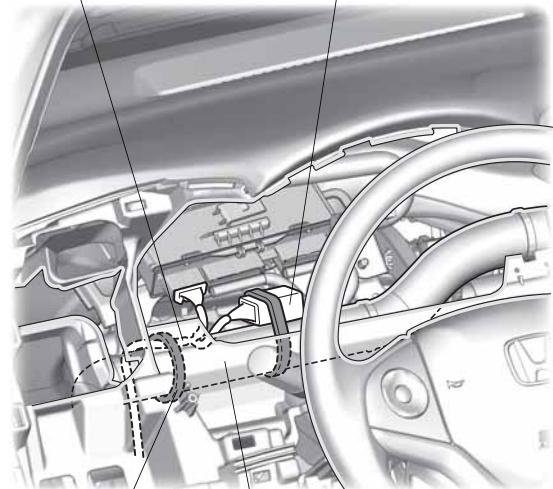

2 LONG WIRE TIES

VEHICLE HARNESS

QC71707AJ

56. Unplug the vehicle 2-pin connector from the subrelay box, and plug it into the engine starter harness 2-pin connector. Plug the remaining engine starter harness 2-pin connector into the subrelay box.

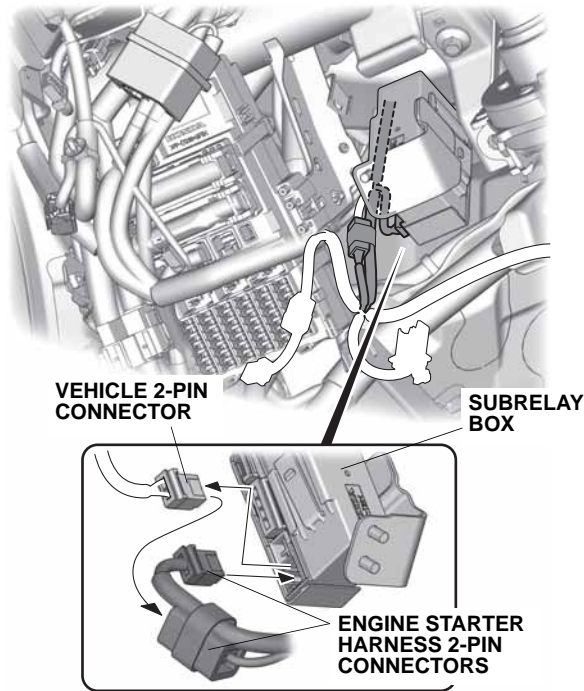

QC71708BJ

57. Reinstall the subrelay box released in step 50.
58. Secure the engine starter harness 2-pin connector to the vehicle harness with one wire tie.

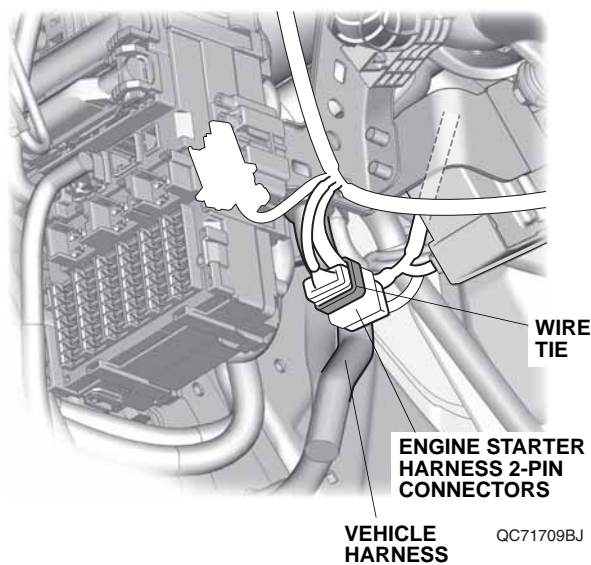

QC71709BJ

59. Plug the antenna cable connector and engine starter harness 28-pin connector into the control unit.

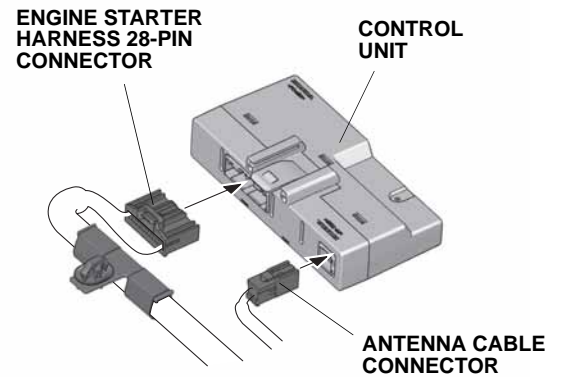

QD22202AJ

60. Using isopropyl alcohol on a shop towel, clean the control unit bracket where the urethane tape will attach.

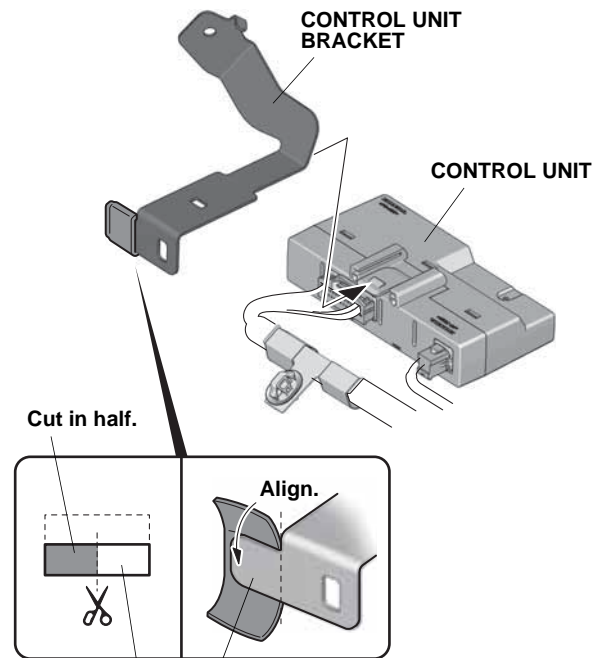

QD22203BJ

61. Using scissors, cut the remaining urethane tape from step 26 in half. Wrap the cut urethane tape around the control unit bracket as shown.
62. Install the control unit bracket to the control unit.

63. Attach the engine starter harness clip to the control unit bracket.

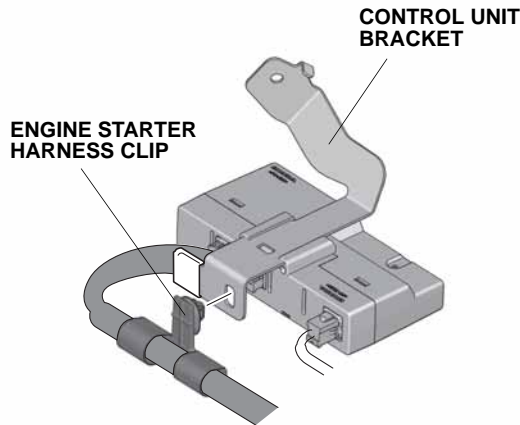

QD22204AJ

64. Secure the subfuse box bracket (removed in step 49) and control unit bracket to the studs with two nuts in the order shown.

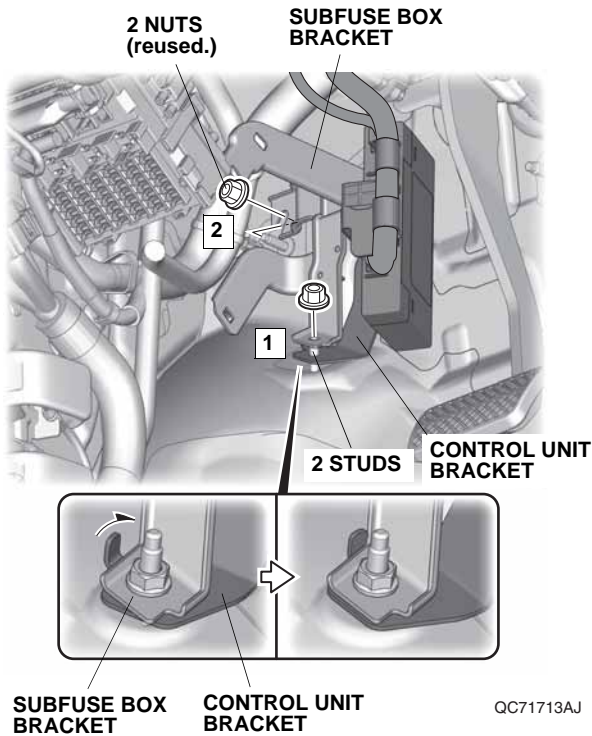

65. Reinstall the subfuse box released in step 48.

66. Secure the engine starter harness fuse block to the hole in the subfuse box bracket. If another accessory relay block is already secured to the holes in the subfuse box bracket, secure the engine starter harness fuse block to another accessory relay block.

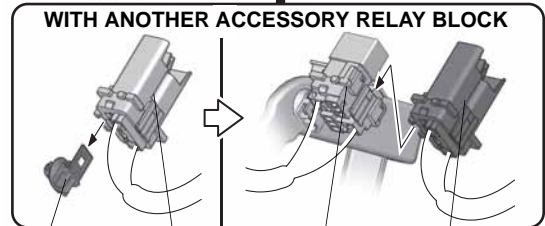
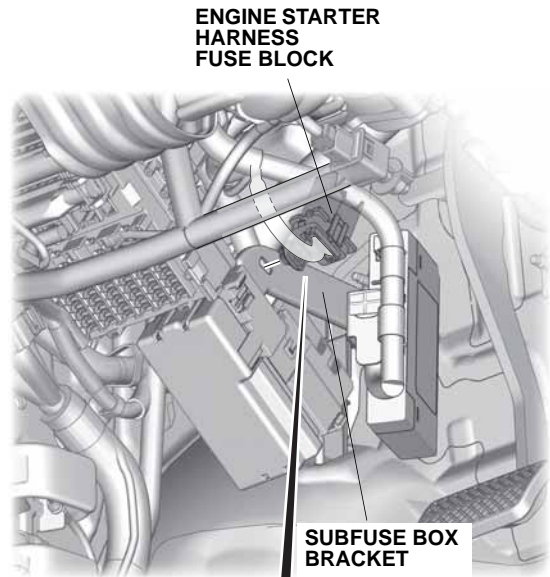

CLIP (Discard.) ENGINE STARTER HARNESS FUSE BLOCK ANOTHER ACCESSORY RELAY BLOCK ENGINE STARTER HARNESS FUSE BLOCK

QC71714BJ

Without Another Accessory Harness 4-pin Connector

67. Plug the engine starter harness 4-pin connector into the fuse box. Go to step 69.

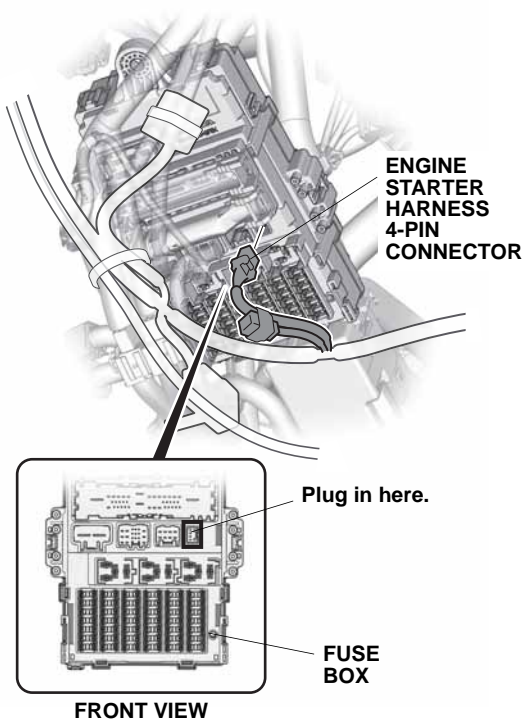

With Another Accessory Harness 4-pin Connector

68. If another accessory harness 4-pin connector is plugged into the fuse box, unplug the 4-pin connector from the fuse box, then plug the engine starter harness 4-pin connector into the fuse box. Plug another accessory harness 4-pin connector into the engine starter harness 4-pin connector.

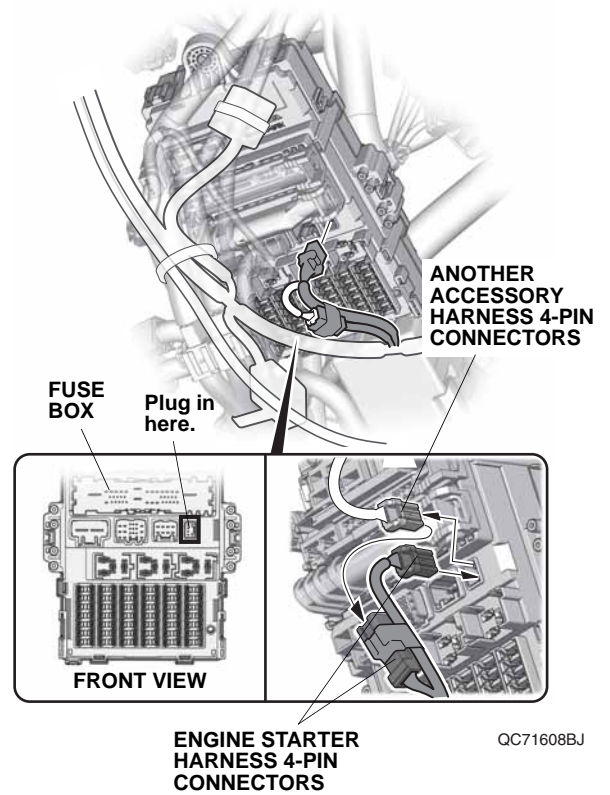

69. Unplug the vehicle 25-pin connector, and plug it into the engine starter harness 25-pin connector. Plug the remaining engine starter harness 25-pin connector into the vehicle 25-pin connector.

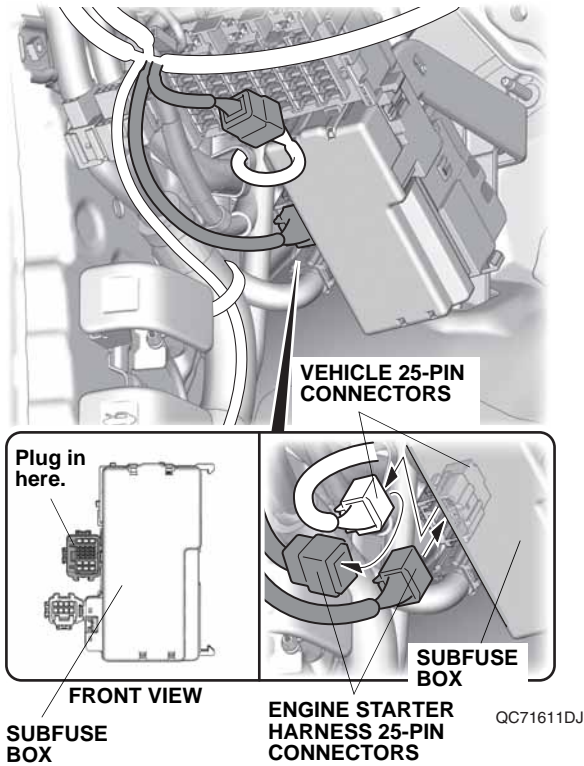

70. Secure the engine starter harness 25-pin connector and engine starter harness to the vehicle harness with one wire tie and one long wire tie.

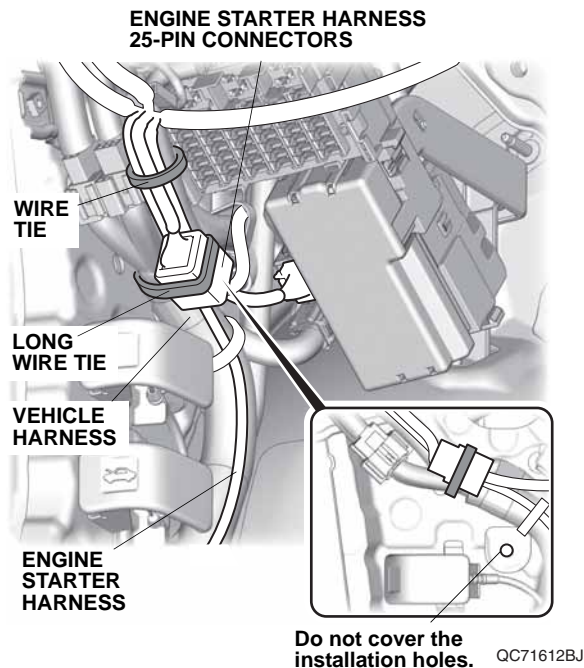

71. Route the engine starter harness behind steering shaft as shown. Secure the engine starter harness relay block to the hole in the vehicle panel.

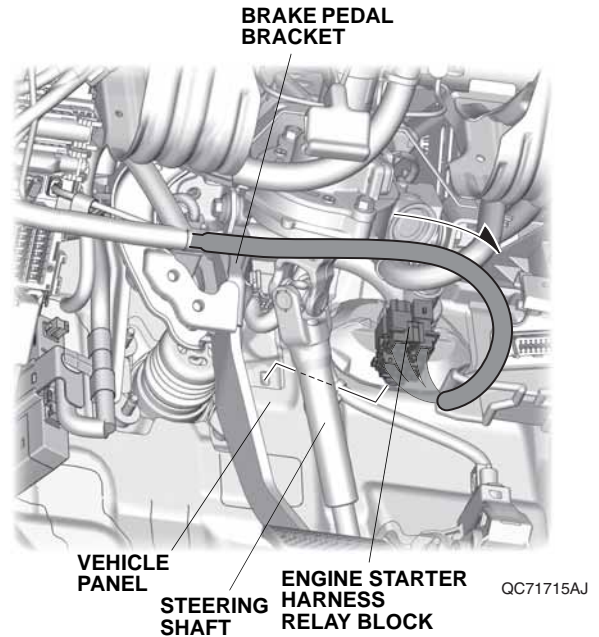

72. Align the white tape on the engine starter harness with the vehicle clip, and secure the engine starter harness to the vehicle harness with four wire ties.

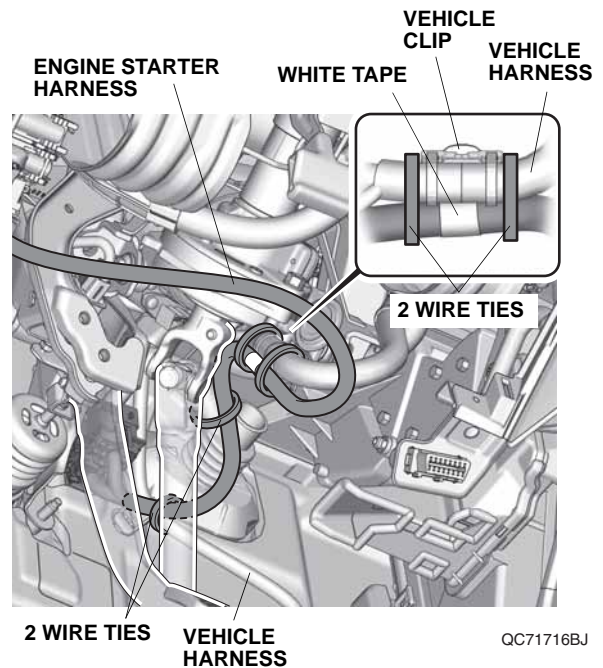

73. Secure the engine starter harness to the steering hanger beam with one wire tie.

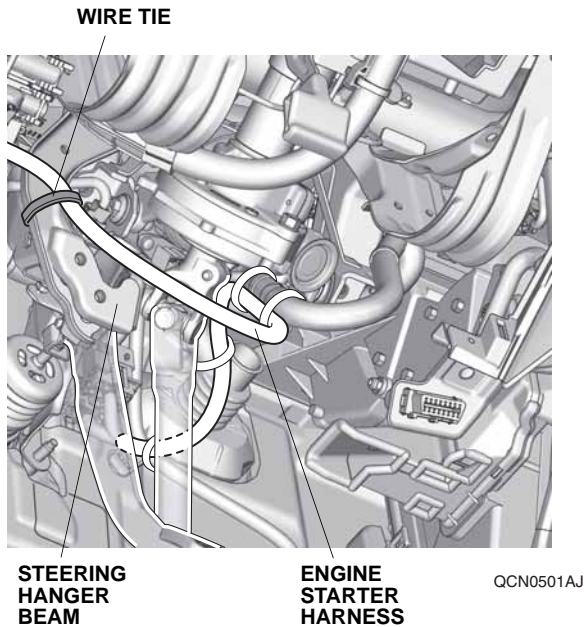

74. Route the engine starter harness along the vehicle harness. Align the white tapes on the engine starter harness with the vehicle clip and end of the vehicle harness protector, and secure the engine starter harness to the vehicle harness with two wire ties.

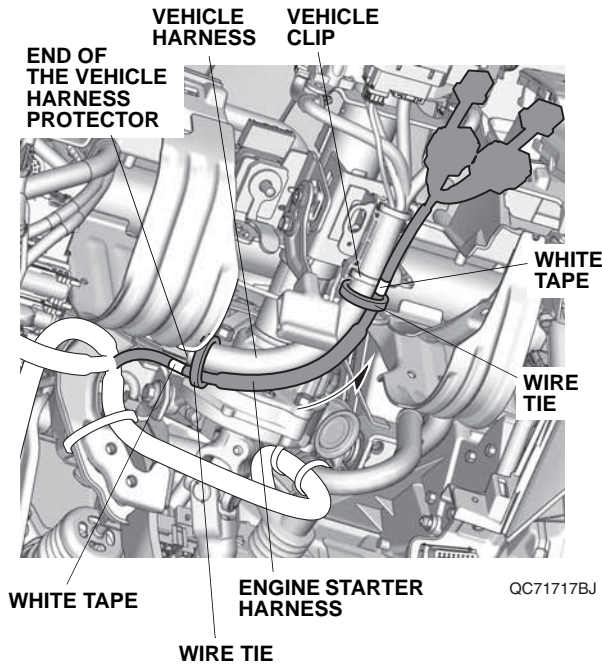

75. Unplug the vehicle 10-pin connector from the wiper switch, and plug it into the engine starter harness 10-pin connector. Plug the remaining engine starter harness 10-pin connector into the wiper switch.

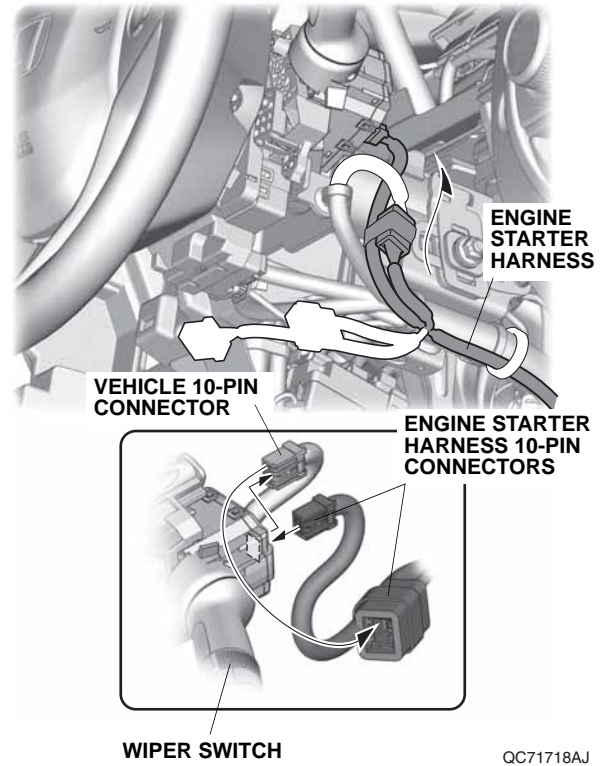

76. Align the white tape on the engine starter harness with the vehicle clip, and secure the engine starter harness to the vehicle harness with one wire tie.

Do not undue strain to the 10-pin connector cord.

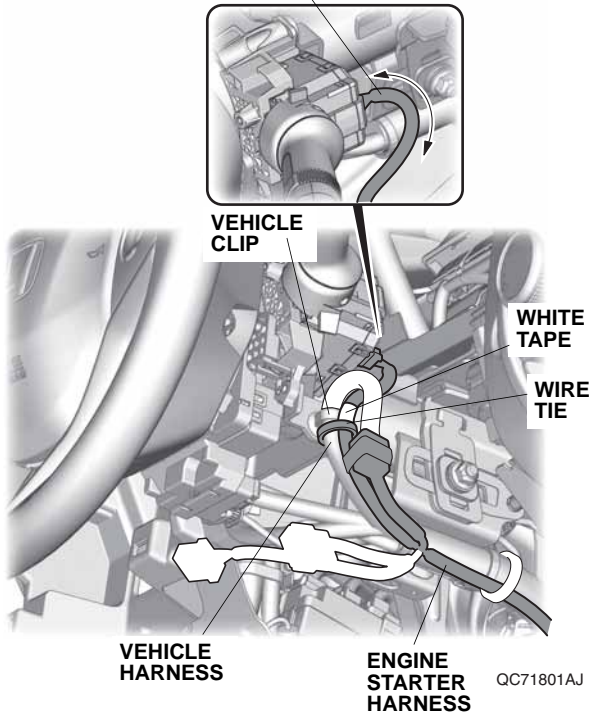

77. Unplug the vehicle 12-pin connector from the combination light switch, and plug it into the engine starter harness 12-pin connector. Plug the remaining engine starter harness 12-pin connector into the combination light switch.

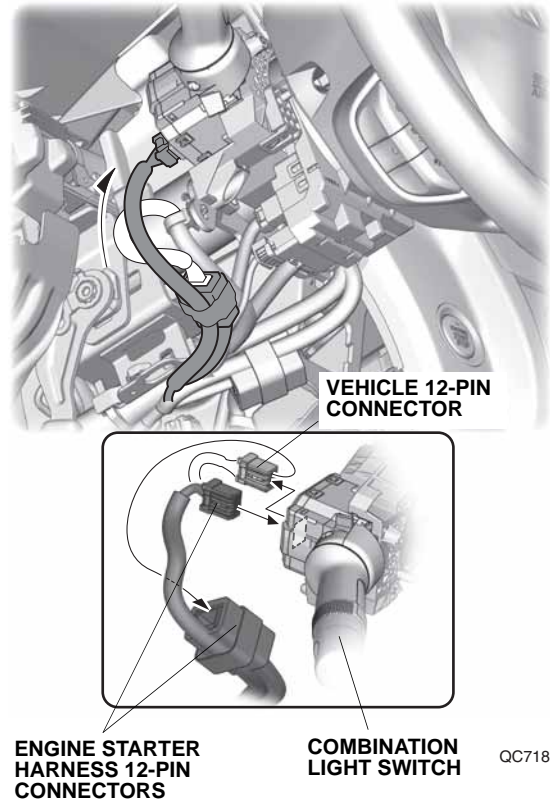

78. Align the white tape on the engine starter harness with the vehicle clip, and secure the engine starter harness to the vehicle harness with one wire tie.

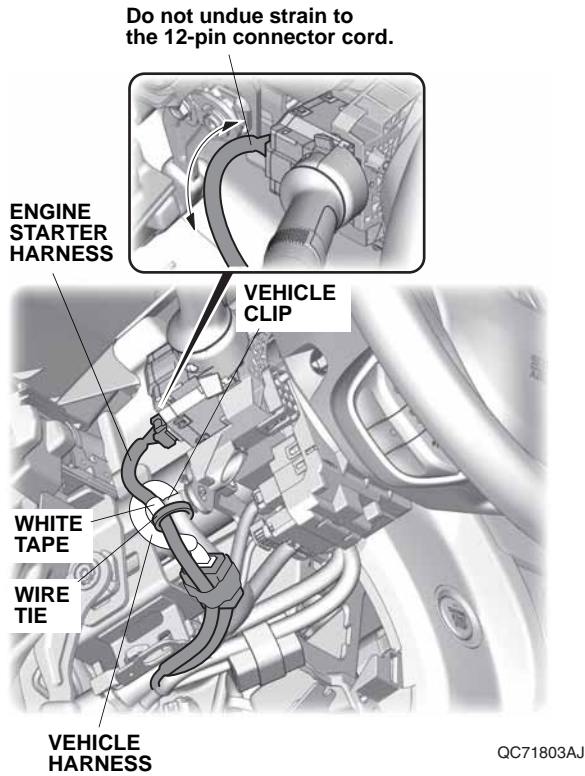

79. Secure the engine starter harness to the vehicle harness with one wire tie.
NOTE: Make sure that the connectors and harness are not pinched, or interfering the steering wheel when moved for adjustment.

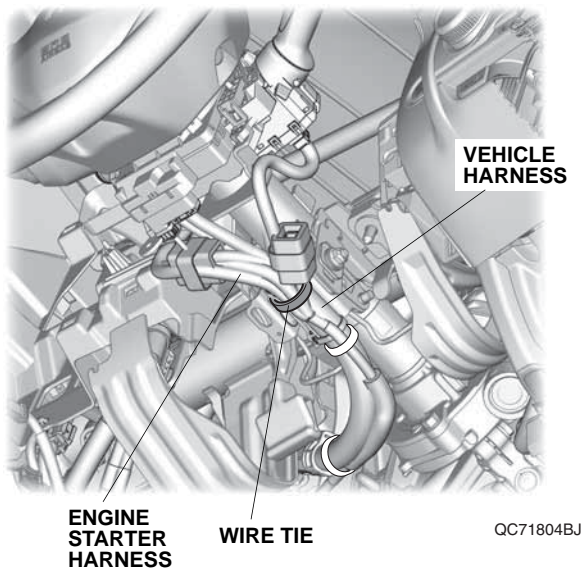

80. Secure the engine starter harness and antenna cable to the knee bolster with one long wire tie.

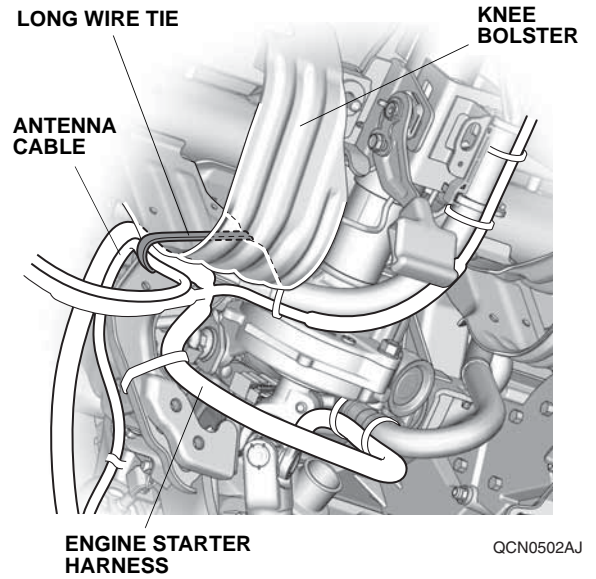

81. Secure one wire tie with clip to the antenna cable and engine starter harness at the white tape, and secure the wire tie with clip to the hole in the steering hanger beam.

NOTE: If another accessory harness is already attached, using diagonal cutters, cut the clip portion off of one wire tie with clip. Align the white tape on the engine starter harness with the clip on the other harness, and secure the engine starter harness and antenna cable to the other accessory harness with one wire tie with clip.

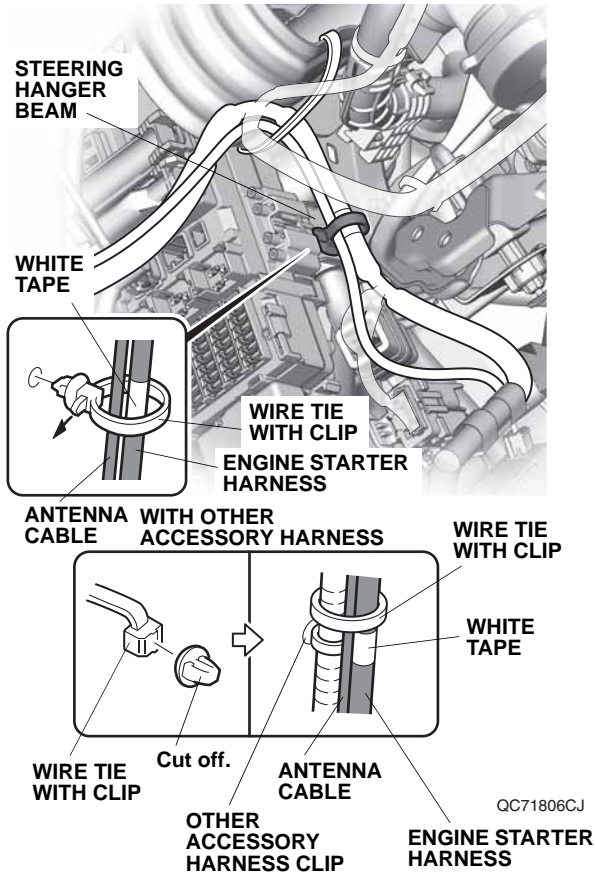

82. Bundle up the excess antenna cable as shown, and wrap one urethane tape around the antenna cable. Secure the antenna cable to the engine starter harness with one wire tie.

NOTE: Do not fold the antenna cable.

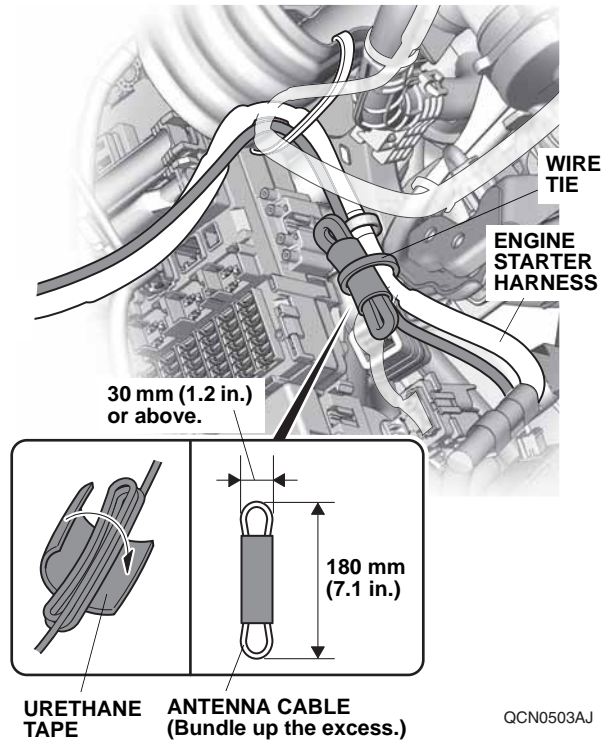

83. Using isopropyl alcohol on a shop towel, clean the lower column cover where the urethane tape will attach.

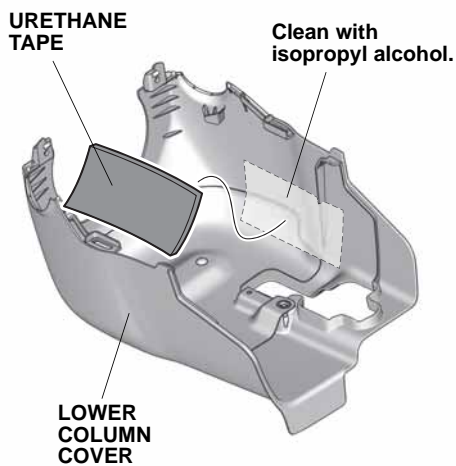

QC71808AJ

84. Attach the urethane tape to the lower column cover as shown.

85. Using isopropyl alcohol on a shop towel, clean the lower column cover where the urethane tape will attach.



QC71809AJ

86. Using scissors, cut the urethane tape in half. Attach the two halves of urethane tape to the lower column cover as shown.

87. Using isopropyl alcohol on a shop towel, clean the hood where the caution label will attach.



QC71810AJ

88. Remove the adhesive backing from the caution label, and attach the caution label to the hood as shown.
89. Check that all wire harnesses are routed properly and all connectors are plugged in.
90. Check the overlap between the headliner and the driver's A-pillar trim. Refer to the Service Manual. If necessary, adjust the overlap.
91. Reinstall all removed parts.
92. Reconnect the negative cable to the battery.
93. Press and hold the radio power button for two seconds to restore the radio and navi (if equipped) system functions.
94. Reset the clock.
95. Restore the systems back to normal operation as described in the Service Manual if necessary.
96. Perform the "REMOTE ENGINE STARTER REGISTRATION" and the "FUNCTION CHECK."

REMOTE ENGINE STARTER REGISTRATION

NOTE: Register after making sure the HDS has been upgraded to the latest version as described in the Service News.

1. Acquire the PCM Code from the Interactive Network.

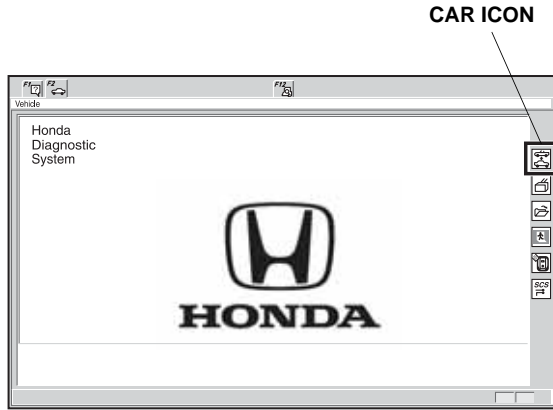

QC31909AC

2. Connect the HDS/MVCI tester to the OBD II data link connector, then press the engine switch to ON.
3. Start the HDS, and click the car icon.
4. Input the VIN and other required information into the HDS, then click the check button.

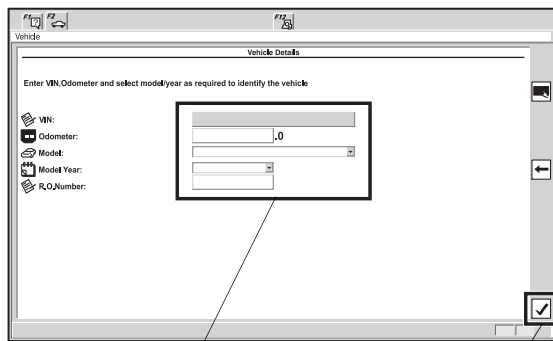

Input the VIN and other required information.

CHECK BUTTON

QB32102BH

5. Select **Honda Systems**, then click the check button.

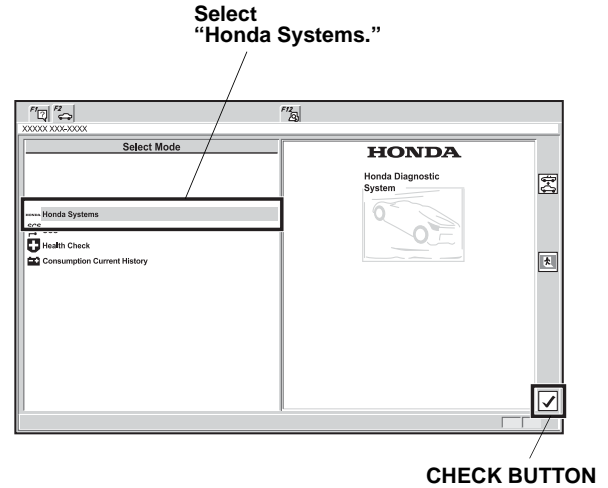

QB32103AH

6. Select **R/C ENG STARTER** and click the check button.

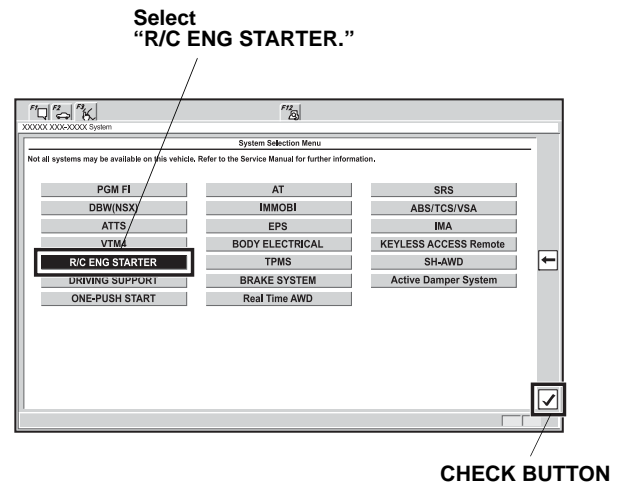

QB32104AH

7. Select **REGISTER REMOTE CONTROL ENGINE STARTER UNIT**, then click the check button.

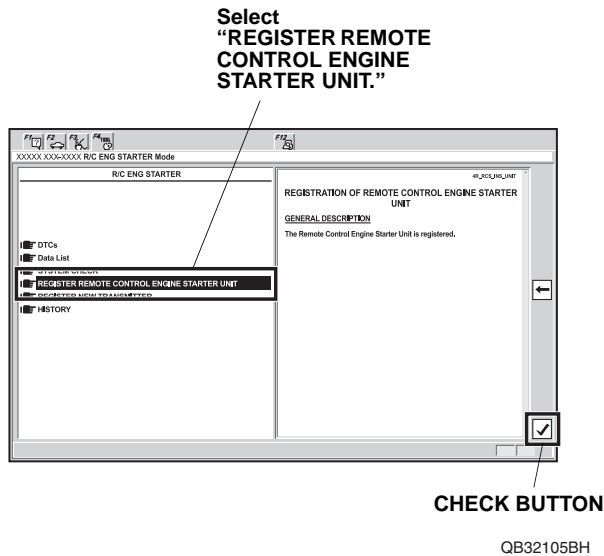

8. The following message will display: **Obtain PCM-code (IMMOBILIZER PCM CODE) from iN. This vehicle's VIN will be required to obtain the password. (USA)** Click the check button.

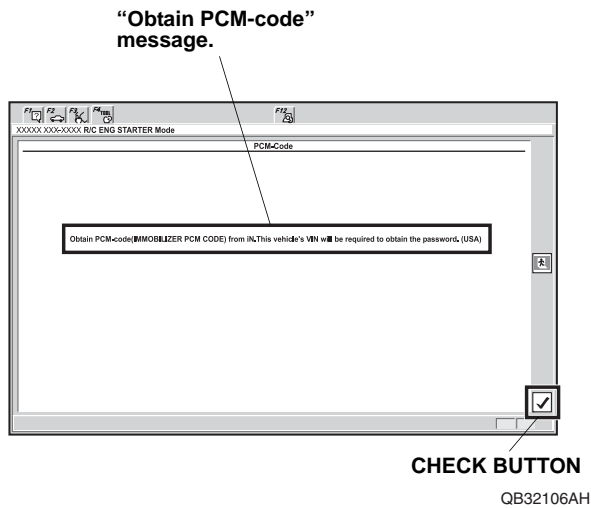

9. Input the PCM-code, then click the check button. **NOTE:** To ensure security, the PCM-code (password) is changed everyday, so it is impossible to register the remote control engine starter if the dates of the PCM-code acquisition and registration are different. The date of the HDS/MVCI tester should also be the same.

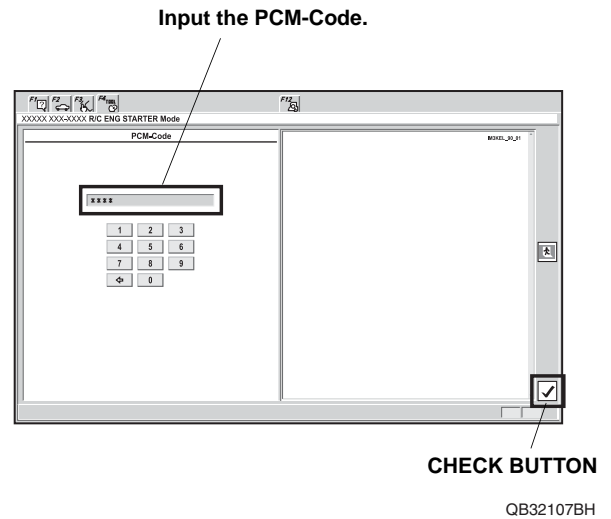

10. The following message will display: **The registration of the Remote Control Engine Starter Unit has been completed.** Press the engine switch to OFF.

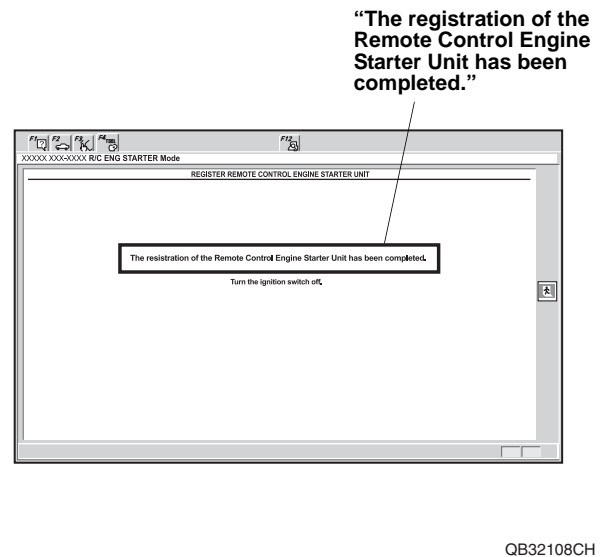

11. The following message will display: **Check that engine can be started by the Transmitter.** Click the check button.

“Check that engine can be started by the Transmitter.”

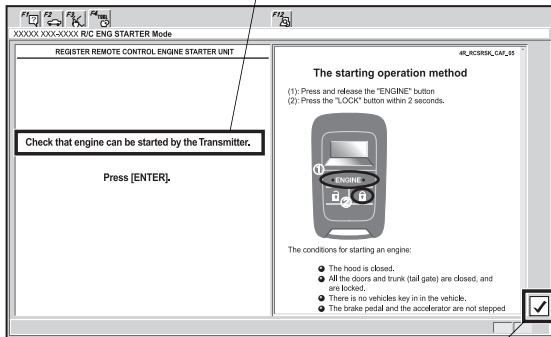

CHECK BUTTON QB32109CH

12. Perform the FUNCTION CHECK on page 31, then disconnect the HDS/MVCI.

FUNCTION CHECK

Operating Conditions

- The hood is closed
- The shift lever is in park
- Press the engine switch to OFF and the key is outside the vehicle
- All doors and tailgate closed and locked

Inspection

1. Press the engine/command button on the transmitter and release, within 2 seconds, press the lock/start button on the transmitter.

The engine should start if all operating conditions are met.

Does the engine start?

Yes - Operation is normal.
No: <ul style="list-style-type: none"> • Make sure all "Operating Conditions" are met. • Check the engine starter harness connections. • Connect the HDS/MVCI and check for an indicated failure. (Refer to the appropriate Service Manual for details.)

2. Press the engine/command button on the transmitter and release, within 2 seconds, press the unlock/stop button. The engine should stop.

Does the engine stop?

Yes - Operation is normal.
No - Check the engine starter harness connections.

3. After the engine has stopped, start the engine again, and check that the engine stops after each of the following conditions:

NOTE: After each test the ignition key must be cycled, or the driver's door must be opened and closed.

- Move the shift lever out of the P position.
- Unlock or open the doors or the tailgate.
- Open the hood.
- Press the engine switch.
- Press on the brake pedal.

Does the engine stop after each of these tests?

Yes - Operation is normal.
No - Check the engine starter harness connections.

4. Check that the power windows and the moonroof do not function, and the shift lever does not move to any position when the engine is started with the transmitter.
5. Check that the engine does not start under "Operating Conditions" with the key left inside the vehicle.
6. Start the engine again, press the engine/command button on the transmitter two times, and check the vehicle condition on the display.
7. Check the operation of the transmitter when the vehicle is 120 m (400 ft.) away and in direct sight.

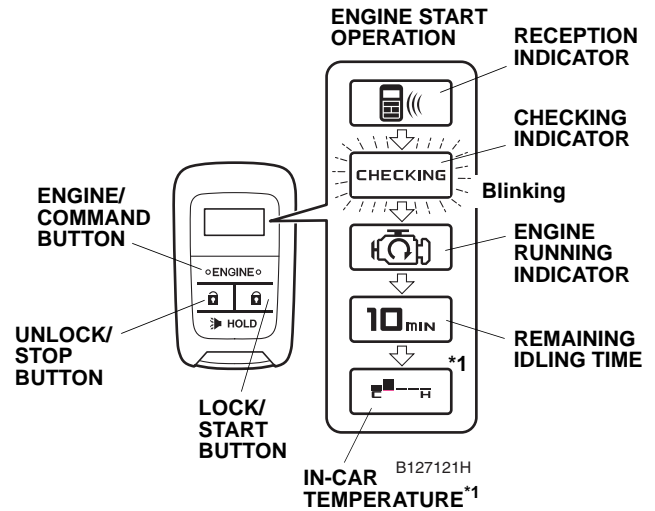

*1 Only on vehicles equipped with the automatic climate control. This indicator is displayed for some vehicles among them.

8. Press the unlock/stop button on the transmitter and verify that the doors unlock. Press the lock/start button, and verify that the doors lock.
9. Check that the engine can start by the vehicle key and that the wiper and the headlight can be operated normally.